

VASTU VIDYA

The Art and Science of Perfect Placement



By Acharya Shivanshu Verma

Copyright © 2025 by Shivanshu Verma

All rights reserved.

No part of this publication may be reproduced, distributed, or transmitted in any form or by any means, including photocopying, recording, or other electronic or mechanical methods, without the prior written permission of the author, except in the case of brief quotations embodied in critical reviews and certain other noncommercial uses permitted by copyright law.

For permission, requests or more information, please contact the author at:

Email: divyamahavastu2023@gmail.com

ISBN: 978-93-343-7319-6

Printed in India

ABOUT THE AUTHOR

With over 15 years of experience in the mystical fields of Vedic Vastu, Vedic Astrology, Prakruti, and Marma Healing, Shri Shivanshu Verma, the founder of Divya Mahavastu, has become a trusted name across the globe. His expertise has not only impacted India but has also resonated in countries like Russia, United Kingdom, China, UAE, and more.

Shri Verma is a versatile and highly accomplished consultant, known for his ability to provide actionable insights and guidance across diverse industries. His approach is unique: blending ancient wisdom with modern-day challenges. Over the years, he has advised businesses ranging from medical colleges to the pharma, jewelry, food, FMCG, animal feed, and even the solar panel manufacturing industries.

What sets Shri Verma apart is his ability to tailor solutions to fit the unique needs of every client. Whether it's battery manufacturers, agro-based businesses, or e-riksha producers, he brings a fresh perspective that bridges the gap between age-old knowledge and contemporary industry challenges. His comprehensive understanding of ancient wisdom has empowered countless clients to unlock their full potential, make informed decisions, and experience sustainable growth.

Shri Verma has also worked with a wide range of sectors — from dentists and pharmaceutical developers to real estate developers, clothing retailers, and even mutual fund managers. His expertise in integrating ancient principles with modern solutions has made him an indispensable advisor in corporate gifting, banking, and other service-driven industries.

A visionary at heart, Shri Verma is not just a consultant but a guide, helping businesses and individuals thrive by combining spiritual wisdom with practical business strategies.

ABOUT THE BOOK

Vastu Shastra: The Art and Science of Perfect Placement is a transformative guide that bridges ancient wisdom with modern living. Written by Shri Shivanshu Verma, this book offers profound insights into how the ancient science of Vastu can be applied to optimize the energy of any space, creating harmony and enhancing well-being.

Shri Verma unpacks the complexities of Vastu Shastra, covering its fundamental principles, from the five elements to directional influences, and offering actionable solutions for everything from residential spaces to commercial properties. Through a systematic approach, this book helps readers understand how to make their living and working environments more aligned with nature, unlocking pathways to success, health, wealth, and spiritual growth.

With real-world applications, this book equips you with tools for overcoming obstacles, improving mental clarity, fostering positive relationships, and enhancing business ventures. It also introduces simple remedies and strategies to balance energies and eliminate Vastu flaws without costly renovations, making this ancient science accessible to all.

Whether you're a homeowner, architect, or business leader, Vastu Shastra provides the knowledge you need to create spaces that support your goals and aspirations—living a life filled with peace, prosperity, and fulfillment.

Index

1. Introduction to Vastu Shastra	7
2. Effects of the Entrances (32 Entries) and Virtual Entries (11 Entries).....	17
3. Powers of the 16 vastu zones.....	25
4. Influence of the Five Elements and its Management Chart	39
5. Vastu Flow Chart and Bar Chart	49
6. Treating the Cut and Extended zones	51
7. Rooms Allocation as per Vastu.....	59
8. Interior Object Allocation as per Vastu	71
9. Tri Doshas and Remedies Vata, Pitta & Kapha.....	79
10. Industrial Vastu	81
11. The Importance of Vastu in Hotel Design.....	89
12. The Importance of Vastu in Hospital Design	93
13. Vastu for Shops, Showrooms, and Offices	97
14. Vastu for Schools, Colleges, and Universities	111
15. Plants and Trees as per Vastu: Enhancing Your Environment ..	117
16. 45 Devtas of Vastu.....	121
17. Vastu Helix and its uses	145
18. Vastu Spring and its uses.....	151
19. Stud and its uses.....	153
20. Vastu Programming or Balancing.....	155
21. Frequent Ask Questions	183



Chapter 1

Introduction to Vastu Shastra

Summary

Vastu Shastra is an ancient Indian science of architecture that aims to create buildings in alignment with the forces of nature. It integrates the five fundamental elements—Earth, Water, Fire, Air, and Space—into spatial design to establish harmony between the physical structure and universal energy. When a space is balanced according to these principles, it promotes health, wealth, peace, and prosperity.

Rooted in the deep understanding of natural laws, our sages developed Vastu as a systematic and scientific approach. They took into account the Earth's magnetic field, the gravitational pull, solar radiation, wind directions, rainfall, and other cosmic influences when planning structures. This knowledge, preserved over generations, is now being researched and applied in modern architecture to enhance human well-being.

Man is both the creator and the subject of architecture. Through Vastu, he aligns his environment with his inner energies and experiences. Each element in nature has a unique role: Earth and Water are foundational for life, while Air, Fire, and Space are universal forces that can be molded through conscious design. Vastu helps in optimizing these energies by assigning specific roles and attributes to each direction of a space.

The texts of Vastu also incorporate traditional Hindu (and sometimes Buddhist) beliefs, focusing on geometrical patterns, directional alignments, spatial measurements, and layout. Its core goal is to merge architecture with nature in a functional yet spiritual way.

The impact of topography and geography on human behavior is also acknowledged in Vastu. For instance, certain regions are known for specific human tendencies—technical innovation in Germany, pharmaceutical development in Switzerland, or miniaturization in Japan. These are believed to be linked to the natural energies and orientation of the land.

Real-life examples, like former U.S. President Jimmy Carter experiencing healing in China through alternative treatments, are cited to show how environment and energy systems influence well-being.

In essence, Vastu Shastra is not superstition, but a subtle science that links nature, energy, and structure. By aligning our living or working spaces with natural laws, we can significantly improve various aspects of our lives—be it mental clarity, health, financial flow, or emotional harmony.

Through Vastu we can achieve the following;

- | | |
|-------------------------------------|-------------------------------|
| 1. Clarity of mind | 9. Control abnormal behavior |
| 2. Joy and happiness | 10. Strengthen family bonding |
| 3. Overcome anxiety | 11. Maximize industrial pro |
| 4. Let money flow | 12. Heal depression |
| 5. Getting fame and recognition | 13. Financial support |
| 6. Power and confidence | 14. Best product quality |
| 7. Stop wastage of money and energy | 15. New opportunities |
| 8. Improve studies | 16. Health and healing energy |

Points to Remember While doing Vastu

- **Always Use Scaled Layout Plans:** Ensure your building plan is drawn to scale with precise measurements. Accuracy is crucial for correct zone identification and energy assessment.

- **Remedies Should Match Symptoms:** Apply Vastu remedies only when the observed symptoms clearly align with known Vastu imbalances. Never implement corrections based on assumptions.
- **Follow Client Inputs, Not Guesswork:** Don't presume or speculate about issues. Listen carefully to the client and assess the space based on their real experiences and concerns.
- **List Problems and Prioritize Goals:** When working on your own property, start by writing down all the challenges you're facing and the goals you wish to achieve. Then focus on addressing the most critical issue first.
- **Avoid Applying All Remedies at Once:** Vastu corrections must be implemented gradually. Tackle one problem at a time, in order of importance. This ensures clarity in results and avoids energy confusion.
- **Monitor the Impact of Remedies:** After applying a remedy, closely observe any changes in the environment, behavior, or results. Every space responds differently, and small shifts can indicate progress.
- **Reassess If No Results in 45–60 Days:** If there is no noticeable improvement within 1.5 to 2 months, revisit your plan, re-analyze the layout, and adjust the remedy as needed. Vastu is a dynamic process and may require fine-tuning.

4-Step Method for Effective Vastu Solutions

1. Entrance checking (32 entries)
2. 16 Vastu zones checking
3. Five elements checking
4. Vastu remedies for balancing

When analyzing a space, begin by observing the door's location and its impact. Next, assess the placement of rooms within different zones and their effects. The third step involves evaluating the balance of the five elements. Finally, consider space programming—how the space relates to positive or negative events.

To effectively address issues, clearly identify each symptom. Prioritize the most urgent problems based on the observed symptoms, applying solutions according to the outlined steps. Monitor the effects over a few days. As one symptom resolves, others may emerge, which should then be addressed sequentially. This phased approach is crucial for successful treatment. Whether designing new spaces or rectifying existing ones, the focus is either achieving specific goals or resolving existing problems.

So, in all, there are four types of work-areas in Vastu Shastra:

1. To solve problems being faced in a built- up structure or a building or a space;
2. To achieve some targets in a built-up structure;
3. To solve the existing problem while proceeding to build a new structure; and

To build a new building in a manner to enable it to manifest its particular purpose

And in all these four, the correct sequence is very important in Vastu Shastra. Distorting the procedural order won't yield desired results, emphasizing the need for a systematic approach. Importantly, only treat observed symptoms; avoid interventions if no problems exist. Treatment is warranted solely when symptoms perfectly align with known issues. This clarity ensures precise thought and action, leading to accurate outcomes. Vastu Shastra is a science, leaving no room for "maybes." It asserts that specific actions, performed correctly, will unfailingly produce predictable results. Mastery lies in proper practice.

Get To-The-Scale' Building Plan First

Before analysing any space through the systematic 4-Step vastu method, it is very important to make an accurate to-the-scale plan of that space.

A plan drawn to scale is always a good idea as it gives you the exact measurements needed to study the 16 vastu Zones.

Drawing to scale, or creating an exact proportional representation of a particular space is just a matter of careful measurement.

1. Draw a Rough Sketch

- **Sketch the Outer Walls:** Start by drawing the approximate shape of the area's exterior walls on your notepad.
- **Measure and Note Walls:** Use a measuring tape to get the lengths and widths of all walls, then write these measurements on your sketch.
- **Locate Windows and Doors:** Measure and mark the positions and widths of all windows and doors.
- **Add Fixed Features:** Note the dimensions and locations of permanent fixtures like counters, beds, and tables.
- **Outline Clearly:** Trace your entire sketch in black ink using a ruler for a clear, easy-to-read floor plan.

2. Make a To-The-Scale Plan of the Building

- **Choose a Scale:** Select a scale that fits your room dimensions and graph paper (e.g., 6 inches or 1 foot per square). Ensure easy conversion and that the entire plan fits on one sheet.
- **Transfer Walls and Fixtures:** Using a pencil and straight edge, accurately transfer the dimensions and locations of walls and built-in fixtures to the graph paper, maintaining your chosen scale.
- **Add Windows:** Draw an additional line parallel to the wall line, about 1/8 inch outside the room, at the window locations.
- **Add Doors:** Erase the wall line where the door goes. Draw a perpendicular line from the hinge side, the length of the door. Connect its end to the wall where the door would rest when closed, using a compass rotated from the hinge point.

3. The Importance of a Detailed Floor Plan Checklist

To ensure an accurate analysis of your home, a comprehensive checklist is crucial for your floor plan. Every detail, no matter how small—from a showpiece to a painting or any other seemingly insignificant object—can impact the analysis. Life's accomplishments are often the result of meticulous attention to detail, and the same applies here. Therefore, carefully and accurately mark every activity and object on your plan. The following checklist outlines all the parts of a house that must be verified when completing your home plan:

A. Entrance

B. Room Locations

- | | |
|--------------------|---------------------------|
| 1. Stair case/lift | 9. Puja / Meditation room |
| 2. Living room | 10. Study room |
| 3. Family lounge | 11. Dining room |
| 4. Bedrooms | 12. Store |
| 5. Guest room | 13. Exercise room |
| 6. Toilets | 14. Servant room |
| 7. Dressing Room | 15. Car Parking |
| 8. Balcony | |

C. Status of the Five Elements Water

- | | |
|---------------------|-------------------------|
| 1. Boring | 4. Black or blue colour |
| 2. Underground tank | 5. Wavy shape |
| 3. Pit | |

Air

- | | |
|--------------------------------|------------|
| 1. Garden and plants | 4. Balcony |
| 2. Green or brown colour | 5. Shaft |
| 3. Rectangular and oval shapes | |

Fire

- | | |
|------------------------|----------------------|
| 1. Gas Burner | 4. Heater |
| 2. Fire place position | 5. Red/Orange colour |
| 3. Geyser | 6. Triangular shape |

Earth

- | | |
|------------------|------------------|
| 1. Yellow colour | 3. Storage |
| 2. Square shape | 4. Overhead tank |

Space

- | | |
|-----------------------------|----------------------------|
| 1. Grey and metallic colour | 3. Vacant Area open to sky |
| 2. Round shape | |

D. Objects in a House

- | | |
|----------------------------|---------------------------------|
| 1. Television | 13. Computer |
| 2. Mixer and Grinder | 14. Refrigerator |
| 3. Fountains and Aquariums | 15. Paintings |
| 4. Beds | 16. Sculptures |
| 5. Guest bed | 17. Family photographs |
| 6. Servant bed | 18. Electric meter and Fuse box |
| 7. Music system | 19. Photographs of ancestors |
| 8. Washing machine | 20. Study table |
| 9. Safe/ Locker | 21. Inverter/Generator |
| 10. Dustbin | 22. Plants and Flowers |
| 11. Gas cylinders | |
| 12. Mirror | |

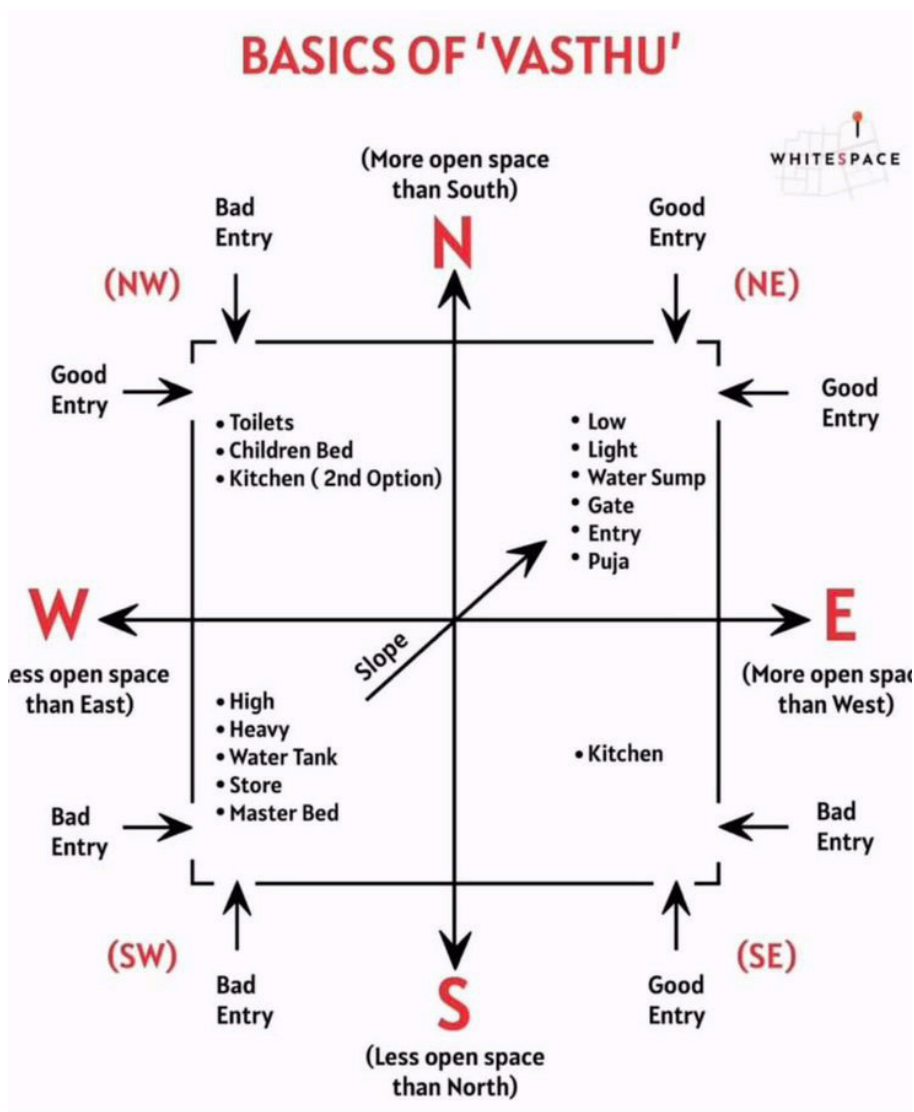

Reading Directions Accurately from Compass

Understanding how to use a Vastu or magnetic compass is fundamental. The core principle is simple: the compass needle consistently points to the Earth's magnetic North. Given that Vastu demands extreme precision, even accounting for a quarter of a degree, it's highly recommended

that aspiring Vastu experts use an oil-filled compass. The following steps and precautions are essential for accurate readings:

1. **Positioning the Compass:** Stand parallel to a reference wall on the site. Hold the compass's baseplate flat and horizontally at chest level, ensuring the needle floats freely and points to magnetic North. Remember, a compass needle's sole function is to point to magnetic North.
2. **Aligning for Magnetic North:** Rotate the entire compass housing until the needle perfectly aligns within the orienting arrow, typically a red stencil on the compass base. The zero-degree mark on the housing and the North end of the needle should coincide. At this point, the compass is pointing perfectly to magnetic North. Crucially, note that this reading is relative to the wall you're referencing and should be recorded alongside the building's plan.
3. **Accuracy is Paramount:** Learning to take precise compass readings is critical. An error of even five degrees can render your entire calculation inaccurate and lead to failure, potentially miscalculating nearly half an entrance. Therefore, the maximum permissible error limit is a mere one or two degrees.
4. **Important Precautions While Using a Compass:**
 - **Avoid Magnetic Interference:** Ensure no magnetic objects like mobile phones, laptops, speakers, or any iron items are near the compass, as they can affect the needle's accuracy.
 - **Beware of Electrical Interference:** Confirm there are no overhead or underground electric or telephone cables or wires where you're standing, as these can also interfere with the compass needle.
 - **Choose an Unobstructed Location:** Do not stand under lintels, slabs, or canopies reinforced with iron bars. The best practice is to determine the correct direction by standing outside the building on clear ground and taking multiple readings from different spots on the site.

The Crucial Role of Accurate Directions in Vastu

Accurate directional analysis forms the bedrock of Vastu, influencing energy flow. Unfortunately, this vital aspect is often overlooked or misinterpreted, leading to ineffective “Vastu yantras” and costly, fruitless alterations. Such misapplication causes Vastu to be dismissed as baseless. In reality, Vastu precisely defines 16 Vastu zones, each a 22.5-degree segment of the 360-degree space. Each zone governs a specific life aspect, underscoring the critical importance of precise directional readings for genuine Vastu benefits.

Chapter 2

Effects of the Entrances (32 Entries) and Virtual Entries (11 Entries)

Understanding Entrance Effects in Vastu

The entrance of a space profoundly impacts its energy, whether positively or negatively. To analyze these effects, you need to accurately identify the entrance's location on a scaled floor plan. Vastu employs a unique "Angular Divisions Method": the 360 degrees around a space's center are divided into 32 equal 11.25-degree sections, each representing a potential entrance. This precise approach sets Vastu apart. By noting the space's directions and marking the entrance on your map, you can then match observed symptoms to rectify the ill-effects of a poorly placed entrance.

Pinpointing Your Home's Entrance Location for Vastu Analysis

Accurately identifying your home's entrance on a map is crucial, as its effects are always powerful, whether positive or negative. To analyze these effects, you need to precisely locate the entrance. Begin by taking your house plan and spreading it flat.

Establishing the Center and Axis:

- Outline all the outer walls of your plan.
- Join them to form a basic square or rectangle.
- Draw diagonals connecting the corners. The point where these diagonals intersect is the center point of your space.
- From this center point, draw a dotted perpendicular line; this line

represents the “Axis” of your plan. This axis is vital as it serves as the reference for marking North and other directions.

Determining Directions on Your Plan: You’ve already learned to take a compass reading. Now, identify one of the walls of your space on the map. Stand facing this wall, keeping the axis in mind.

- Place the compass directly in front of you.
- Observe where the needle points and note down the reading.
- Place a protractor or circle master at the center point of your scaled plan, aligning it with the axis.
- Draw a clear straight line with a color pencil across the plan at the degrees indicated by your compass.
- One side of this line indicates North, and the opposite side is South.

With North and South established, you can find the other cardinal directions:

- East is 90 degrees clockwise from North (to your right when facing North from the center).
- South is 90 degrees clockwise from East.
- West is 90 degrees clockwise from South.
- North is 90 degrees clockwise from West.

Dividing the Space into 32 Entrance Segments: Starting from North, divide the 360-degree circle into 32 parts.

- Mark NE at 45 degrees from North, then SE at another 45 degrees, followed by SW and NW.
- Now, divide each 45-degree segment into four equal parts, each measuring 11.25 degrees. Most building entrances will fall within one of these segments.
- Mark the segments between NE and SE as E1, E2, up to E8.

- Similarly, mark segments between SE and SW as S1 to S8; between SW and NW as W1 to W8; and between NW and NE as N1 to N8.

This method reveals the location of 32 possible entrances to a building. Of these, only nine are considered highly beneficial. Once you've precisely calculated these entrance locations according to Vastu, you can accurately match your building's symptoms with their corresponding Vastu effects.

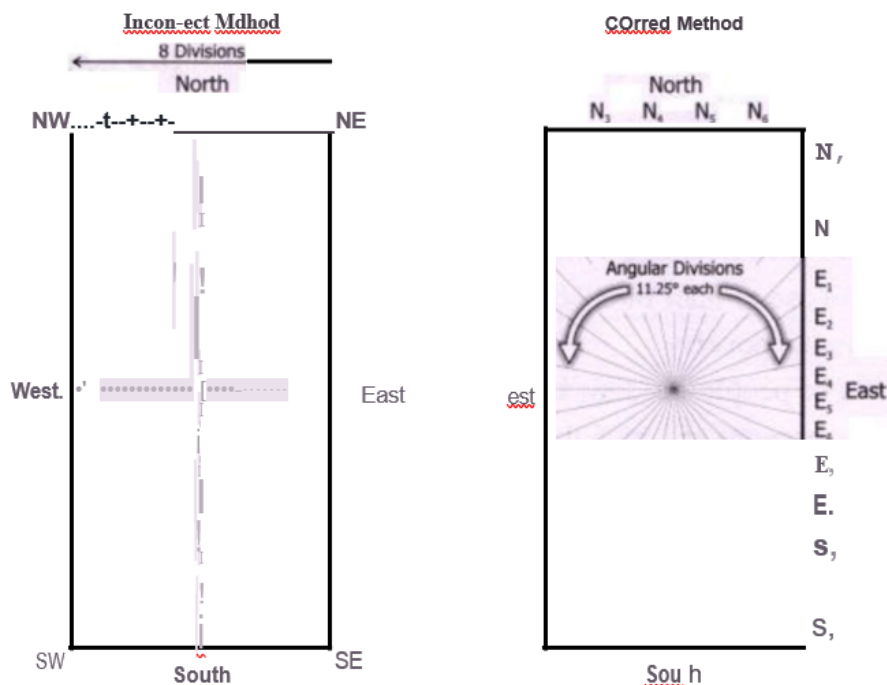

Understanding the 32 Vastu Entrances and Their Effects

Vastu Shastra delineates 32 potential entrance points for any structure, each carrying distinct positive or negative impacts on its occupants' lives. These entrances are categorized by direction, with specific effects associated with each.

North Entrances (N1 - N8)

North-facing plots feature eight entrances, with three considered positive and the rest negative:

- **N1 (Negative):** Increases the likelihood of tragic events like murder and instills unnecessary fears in residents.
- **N2 (Negative):** Fosters jealousy among residents and creates animosity from external individuals.
- **N3 (Positive):** Brings abundant wealth and tends to result in more male offspring.
- **N4 (Positive):** Grants significant inherited property.
- **N5 (Neutral):** Neither positive nor negative; it cultivates a religious inclination in residents.
- **N6 (Negative):** Causes excessive anxiety and promotes rude behavior among inhabitants.
- **N7 (Negative):** Particularly detrimental for girls, leading them to defy family traditions.
- **N8 (Positive):** Highly beneficial for organizations and companies dealing with banks, leading to increased bank balances for occupants.

East Entrances (E1 - E8)

East-facing plots also have eight entrances, but only two are considered positive:

- **E1 (Negative):** Leads to financial losses and increased risk of accidents.
- **E2 (Negative):** Results in higher expenses and a tendency for more female births.
- **E3 (Positive):** Brings money, profits, and overall success.
- **E4 (Positive):** Attracts beneficial gains and support from influential people.

- **E5 (Negative):** Makes residents aggressive.
- **E6 (Negative):** Causes occupants to fail on their commitments.
- **E7 (Negative):** Renders residents insensitive.
- **E8 (Negative):** Associated with accidents, financial losses, and theft.

South Entrances (S1 - S8)

South-facing plots have eight possible entrances, with two considered positive:

- **S1 (Negative):** Creates negative effects for male children, drawing them toward undesirable company.
- **S2 (Positive):** Beneficial for those in MNCs, promoting career growth, regular promotions, and salary hikes.
- **S3 (Positive):** Brings money and success, allowing residents to earn wealth through their reputation and goodwill.
- **S4 (Positive):** Generates wealth through fame, making it ideal for actors and media professionals.
- **S5 (Negative):** Leads to debts and financial losses.
- **S6 (Negative):** The most negative entrance, causing poverty as it's located in the direction of disposal.
- **S7 (Negative):** Results in wasted efforts.
- **S8 (Negative):** Makes residents feel lonely and isolated, disconnecting them from the world.

West Entrances (W1 - W8)

West-facing plots also feature eight entrances, with two deemed positive:

- **W1 (Negative):** Leads to poor financial conditions and a reduced lifespan, with a higher risk of early demise (around 35-40 years old).
- **W2 (Negative):** Causes insecurity, leading to relationship problems and an unstable career.

- **W3 (Positive):** Auspicious, bringing money, growth, and prosperity.
- **W4 (Positive):** Fills residents' lives with happiness.
- **W5 (Negative):** Fosters an over-ambitious attitude where inhabitants demand high value for low-quality products/services.
- **W6 (Negative):** Leads to unfulfilled expectations for residents.
- **W7 (Negative):** Makes inhabitants unhappy and prone to drug addiction.
- **W8 (Negative):** Encourages selfish behavior among residents.

It's tough for everyone to get a house with their ideal entrance. While some might have the option to renovate for a better entrance, many don't, especially those in rental homes or cases where renovation isn't feasible for a good entrance.

In these situations, you can balance the existing entrances by using color or metal strips. Another effective method is to paint the main door with a balancing color that corresponds to its direction.

ENTRANCE BLOCKING BY TAPE/ COLOUR

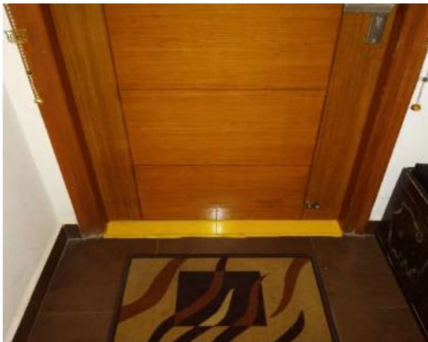

ENTRANCE BLOCKING BY METAL STRIP



32 ENTRIES EFFECT					
Entrance	Positive Effect	Negative Effect	Entrance	Positive Effect	Negative Effect
N1		X	S1		X
N2		X	S2		
N3			S3		
N4			S4		
N5			S5		X
N6		X	S6		X
N7		X	S7		X
N8			S8		X
E1		X	W1		X
E2		X	W2		X
E3			W3		
E4			W4		
E5		X	W5		X
E6		X	W6		X
E7		X	W7		X
E8		X	W8		X

Chapter 3

Powers of the 16 vastu zones

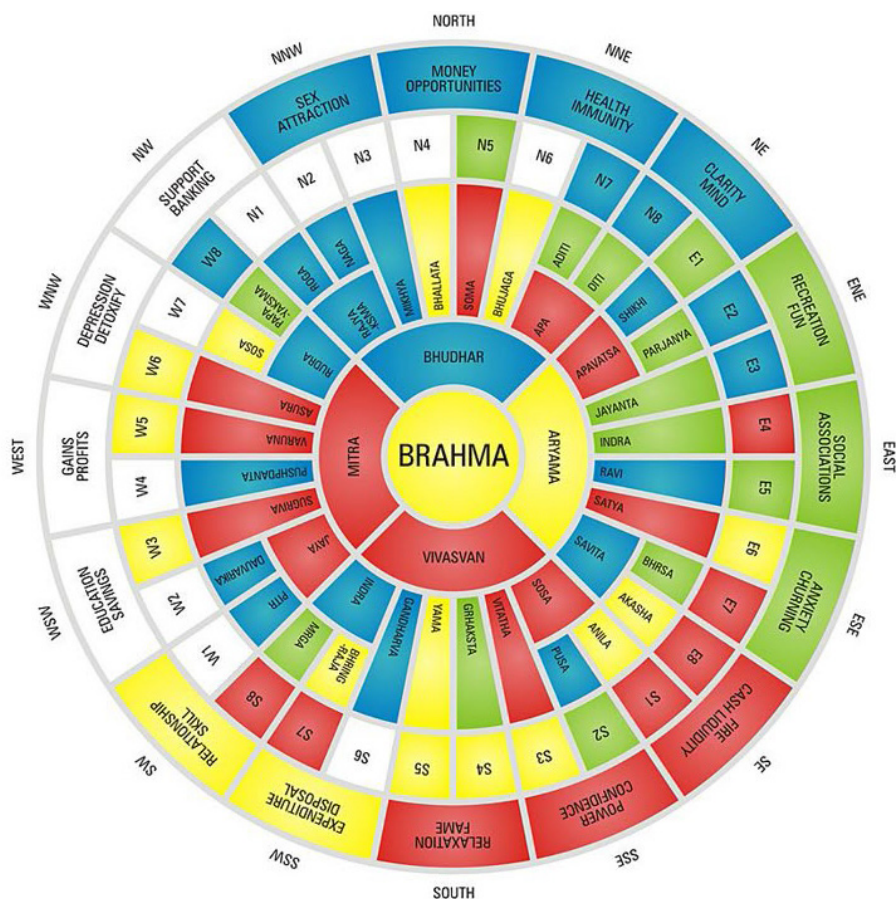

Evaluating Effects of Room Locations: Marking the 16 Vastu Zones

To assess the impact of room placement, you'll need to mark the 16 Vastu Zones on your plan.

Starting with North as your reference point:

- Measure 11.25 degrees to the left (counter-clockwise) and 11.25 degrees to the right (clockwise) from North. This 22.5-degree segment defines the North zone.
- The subsequent 22.5-degree segment, moving clockwise, is the North of North-East zone (NNE).
- Following that, the next 22.5-degree segment is the North-East zone (NE), and so on.

By continuing this precise division around the entire 360-degree space, you will identify all 16 Vastu zones. These zones are crucial for understanding the energetic implications of different room placements within your space.

Through this division, we arrive at 16 Vastu zones, namely:

North (N)	South (S)
North of North-East (NNE)	South of South West (SSW)
North-East (NE)	South West (SW)
East of North-East (ENE)	West of South West (WSW)
East (E)	West (W)
East of South East (ESE)	West of North West (WNW)
South East (SE)	North West (NW)
South of South East (SSE)	North of North West (NNW)

The North Zone: Money and Opportunities in Vastu

The North direction is crucial for attracting money and opportunities,

as it's governed by Lord Kubera, the deity of wealth and treasure. A balanced North zone brings money and prosperity to residents.

This direction provides the transformative power to convert your products and services into wealth. While liquid cash is associated with the Southeast, the path to it originates from the North.

The North-Northwest (NNW) zone is vital for attracting clients seeking your offerings. When balanced, NNW also promotes health and solutions, ensuring smooth transactions to convert your "treasures" (products/services) into money.

Since North belongs to the water element, avoid placing fire or earth elements here, such as red or yellow colors, kitchens, toilets, or dustbins, as they create imbalances.

North-North-East (NNE): Health and Immunity

The North-North-East (NNE) zone, formed by North (treasures/money) and North-East (ideas/vision), governs health and solutions. It's an ideal location for medicines, signifying a system free of blockages. A balanced NNE indicates clear vision for converting efforts into success. Imbalances here, caused by elements like toilets, inverters, fireplaces, red colors, or junk, lead to severe health issues such as low immunity and chronic diseases. Disruptions in NNE also affect the North and North-East zones. This area is perfect for a relaxing lounge or a doctor's consulting room.

North-East (NE): Mind Clarity and Vision

The North-East (NE) direction governs ideas and vision, which originate from our subconscious. For these ideas to manifest, our conscious mind must be receptive. NE is a combination of NNE (solutions) and ENE (creativity). A balanced NNE ensures a mind free from blockages, making it receptive to new ideas. When ENE is balanced, these subconscious ideas become creative and lead to smooth problem-solving.

The North-East is ideal for a meditation or puja room. Just as entering a temple naturally puts your mind in a receptive state, having a puja room here makes residents more open to receiving insights for life's purpose and desires. It's not strictly necessary to meditate daily in this direction; simply placing a revered deity's picture in the NE can strengthen your divine connection and aid in fulfilling your life's purpose.

Conversely, placing a temple in other directions can have different effects. For instance, a temple in the East-South-East (ESE), the direction of analysis, might lead to overthinking and difficulty making decisions. If a temple is in the South-South-West (SSW), the direction of disposal, it can sever your connection with divine energies, making you feel completely disconnected.

East-North-East (ENE): Fun and Recreation

The East-North-East (ENE) direction governs creativity and joy in all aspects of life. When you feel joyful and create products or services with enthusiasm, they attract global attention. ENE energies help you craft the best offerings and are ideal for recreation, making it a suitable location for a bathing area.

Composed of North-East (ideas/vision) and East (social circle/marketing), a balanced ENE fosters creative ideas and a state of happiness. This joy helps you connect easily with the external world. ENE also provides freshness; if you feel stuck or lack newness in life, check your home's ENE zone. Clutter and old storage disrupt this area. Placing multicolored flowers in a green pot in ENE can restore freshness and lost creativity.

East (E): Social Networking and Connections

The East direction profoundly influences your social circle, encompassing clients, neighbors, and siblings. Building connections with the right people is crucial for fulfilling your life's purpose. This direction is ideal for a drawing room at home or a meeting/conference room in an office.

East is formed by the East-North-East (ENE), governing creativity and joy, and East-South-East (ESE), which facilitates analysis. When you're in a joyful state (ENE), you naturally attract external connections. Through discussions and analysis (ESE), you discern who to collaborate with to achieve your goals, fostering a strong social network. Choosing supportive individuals brings immense joy and fulfillment.

Consider customers who purchase your products or services at your set price; they are influenced by the East direction. Politicians rely on strong connections with the masses, also governed by East, to win elections. E-commerce platforms, too, need robust public connections, nurtured by the East direction, to boost sales.

An imbalance in the East direction can make individuals introverted, hindering their ability to express themselves and form necessary connections for business or personal growth. A toilet in the East can completely disconnect you from the world. Conversely, keeping green plants in the East strengthens its energies, helping you build a thriving social circle.

East-South-East (ESE): Analysis and Churning

The East-South-East (ESE) direction grants the ability to analyze various options and make optimal decisions. It represents the power of "churning," much like the ancient Indian story of ocean churning that produced valuable gems, including the Goddess Laxmi (wealth), Amrit (longevity), and Vish (venom). Controlled churning yields beneficial outcomes like Amrit, while excessive churning leads to negative results (Vish), and no churning produces nothing.

For effective decision-making, controlled churning is essential. Overthinking can cause confusion. As the next zone is Southeast (fire and liquid cash), ESE is ideal for a kitchen or placing a mixer/grinder.

However, an ESE bedroom is problematic. Sleeping here can cause excessive overthinking about minor issues, leading to frequent family arguments. Case studies have shown resolving marital disputes by simply relocating beds from ESE.

South-East (SE): The Zone of Cash Flow and Spark

The Southeast (SE) direction, also known as Agni Kon or the corner of fire, is vital for liquid cash flow. It provides the necessary spark to execute decisions made through the churning process of the East-South-East zone.

Beyond finances, Southeast governs the look, feel, and beauty of everything, including your products and services. The initial impression of your offerings, their aesthetic appeal, is crucial for attracting customers. Just as some individuals possess an inherent spark or aura despite their physical appearance, a balanced fire element in a home contributes to a compelling presence. Fire manifests in two forms: literal flames and the metaphorical spark or sense of security in one's life.

Fire is considered highly auspicious, being associated with Goddess Laxmi, who is depicted in red, the color of fire. This is why many Hindu rituals, such as lighting diyas or performing havans, begin with the initiation of fire.

An imbalanced Southeast in any building can lead to cash shortages and frequent accidents. It also causes delays or hurdles in auspicious life events like marriages or childbirth. The presence of blue color (representing water, which extinguishes fire) in the Southeast can result in severe cash crunch and a lack of security.

Furthermore, government departments like Income Tax and Customs are associated with the fire element. If the fire element is weak in a building (home or office), it can attract scrutiny from these departments, leading to financial losses for the inhabitants. The South-South-East (SSE) direction, governing confidence, is adjacent to Southeast. An imbalanced Southeast can, therefore, also lead to a lack of confidence, hindering the initiation of any process.

If you're experiencing any of these issues, lighting a 15-watt red bulb in the Southeast direction can help balance its energies and invite the positive aspects of fire into your life.

South-South-East (SSE): Power and Confidence

The South-South-East (SSE) direction governs the confidence and power needed to initiate and sustain any process, from new businesses to career changes or product investments. While the Southeast sparks initiation, SSE provides the endurance to see tasks through to completion.

At a physical level, SSE provides energy, strength, and zeal. Vastu defects here can cause lethargy and low energy, even in healthy individuals. Mentally, a disturbed SSE leads to a lack of confidence in completing tasks. While North-North-East (NNE) handles general health, an imbalanced SSE specifically impacts energy levels, not necessarily causing disease. A balanced NNE and SSE create a strong and healthy individual.

SSE is suitable for a bedroom at home to foster a strong personality. In offices, it's ideal for staff who need to work long hours, as SSE provides the necessary power and drive.

South (S): Name, Fame, and Recognition

The South direction is associated with relaxation, fame, and brand building for individuals and organizations. It's the ideal direction for a bedroom, as sleep provides deep relaxation. It's also suitable for meditation, promoting tranquility for both mind and body.

This direction governs the fame and brand recognition you gain from your products and services. To achieve market prominence, the energies of the South must be strong. Vastu defects in this zone can hinder brand building, leading to a lack of buyer trust and reduced demand for your offerings.

Observing famous, relaxed individuals reveals a sense of calm around them. Visiting their homes often instills automatic peace, a result of a balanced South direction in their living spaces.

Conversely, Vastu defects in the South can cause problems like sleep disorders, insomnia, and restlessness. South is formed by SSE (confidence)

and SSW (let go). Confidence in execution brings relaxation. Achieving peace of mind requires releasing negative thoughts, which is facilitated by the SSW direction. Thus, balancing adjacent directions is crucial for a harmonious South.

A toilet in the South can severely damage your product's brand reputation and your image among neighbors. Similarly, the presence of blue color in the South disrupts the inherent fire element, creating imbalance.

South-South-West (SSW): Waste and Disposal

The South-South-West (SSW) direction governs the energies of disposal and the power of letting go in a building. It's essential to eliminate unnecessary things and negative energies from your life to overcome problems. However, disposal must be controlled; imbalances, whether excessive or insufficient, can affect both body and mind.

At a physical level, improper waste disposal can lead to constipation and hinder daily tasks. Conversely, excessive disposal can cause sickness, diarrhea, and fatigue, impacting mental function. Therefore, balanced disposal is crucial for both physical and mental well-being.

Mentally, if negative or useless thoughts aren't disposed of, new ideas face blockages. Too much mental disposal, however, can lead to missing new ideas and forgetting routine tasks, negatively affecting performance.

Given its nature, the SSW direction is ideal for toilets, septic tanks, or dustbins, as these activities align with its disposal energies, ensuring a balanced process.

SSW lies between South (peace) and South-West (relations). Vastu defects in SSW can prevent the release of negative thoughts, leading to a lack of peace. In my observations, prolonged storage of clutter or waste in SSW often causes inhabitants to hold grudges, resulting in family clashes and conflicts.

South-West (SW): Skills, Relationships, and Stability

The South-West (SW) direction, also known as Pitrasthan (place of ancestors), holds significant influence over relationships, stability, and skills. At home, it governs family bonding; in the office, it dictates client relationships. Our ancestors are paramount, and their blessings are essential for personal growth, as they are the source of our existence and inherent talents. The quality of our skills directly translates into the financial abundance we receive.

Historically, artisans stored their tools and warriors kept their weapons in the Southwest to enhance their craft and fighting abilities. In contemporary life, this direction is ideal for placing reference materials or tools used in your work. It's also an excellent location for a quality control department in factories.

Relationships are also a key aspect governed by SW, requiring skill and effort to maintain. Disputes often stem from Vastu defects in this direction. To strengthen family bonds, it's recommended to place family photographs in golden frames in the Southwest. However, avoid placing photographs of siblings or cousins here, as it can lead to their increased interference in personal family matters.

The Southwest is diametrically opposite to the North-East (NE). While the NE, where deities reside, provides insights for growth, the SW governs the skills and art required to execute those insights. Due to this opposition, Vastu Shastra advises against worshipping ancestors or placing their photographs in the North-East. Similarly, temples or images of gods/goddesses should not be placed in the Southwest.

The SW zone is composed of South-South-West (SSW - let go) and West-South-West (WSW - education/practice). If SSW has Vastu defects, family members may struggle to "let go" of grudges, leading to prolonged clashes and disturbed relationships, which in turn negatively impact the Southwest. The ability to let go is a crucial skill for healthy relationships.

Learning a skill, like driving, requires initial understanding, but mastery comes from consistent practice, which is governed by WSW, the direction of education and practice. Therefore, balancing all zones is vital. WSW ensures the practice of essential life skills, while SSW facilitates the removal of unnecessary elements, paving the way for new developments and growth.

West-South-West (WSW): Education and Savings

The West-South-West (WSW) direction governs knowledge, education, and savings. This isn't about subconscious insights (North-East), but rather the knowledge gained through formal education, from elders, siblings, or practical work experience. WSW is the direction of "Vidya Abhyas"—the continuous practice and retention of talents and skills.

This zone is ideal for a study or dining area, or for placing a fridge, as its energies promote preservation. When a child's study table is in WSW, it ensures good retention, helping them recall studies in exams. If a child forgets everything in exams despite studying, check for a toilet in WSW, as its disposal energies can negate learning.

A dining area in WSW helps the body retain food nutrients. Similarly, a fridge placed here aligns with its preservation qualities.

WSW is also the perfect place for keeping savings, including extra cash, jewelry, and property papers. If you're facing property disputes, storing relevant papers and hanging a black-framed village scene picture in WSW can help protect your assets.

This direction is also suitable for a children's room, as it fosters knowledge acquisition crucial for their development and future success. Your home reflects your subconscious mind, so items placed in WSW yield specific results. A TV here might distract a child from studying, while toys could encourage play instead of academics. Crucially, a toilet or washing machine in WSW can severely impair a child's ability to retain what they study, no matter how hard they try.

WSW is composed of South-West (skills) and West (gains). Vastu defects in WSW can hinder proper skill practice due to a lack of knowledge, thereby impacting your financial gains.

West (W): Gains and Profits

The West zone is directly linked to material gains and profits, ensuring your efforts yield positive outcomes like money, growth, knowledge, or achievements. This energy prevents your hard work from going to waste, providing the drive to work tirelessly and efficiently. Unlike the South-Southeast's internal strengthening tonic effect, this zone's energy is like essential sustenance for achievement.

The West zone is crucial for fulfilling desires. An extended West zone won't necessarily increase gains, but rather inflate expectations, as true fulfillment comes from balance. Conversely, a cut or small West zone leads to unfulfilled desires, results below expectations, and wasted effort. Balanced energies in this zone bring contentment to mind, body, and spirit, paving the way for happiness.

A toilet here negates all gains. A bedroom in the West promotes easy profit flow, while a drawing room ensures fruitful meetings. This zone's energy profoundly influences any activity undertaken within it.

West-North-West (WNW): Stress and Depression

The West-North-West (WNW) direction holds energies for detoxification, primarily at a mental level, making it ideal for a bathing area. This differs from SSW (disposal), which focuses more on physical waste.

In states of depression, individuals often feel useless or despairing, leading to urges to cry or self-harm. Crying, even from happiness, releases negative emotions and brings relief. When the WNW direction is balanced, you naturally release daily emotional and mental stress. However, Vastu defects here can prevent your subconscious from releasing mental blockages, causing suffocation and depression, hindering enjoyment of life.

A storeroom in WNW can accumulate negative thoughts in residents' minds, leading to persistent regrets about the past. Conversely, a kitchen (fire element) in this direction can burn away negative and useless thoughts, leaving occupants feeling fresh and liberated.

WNW is a blend of West (gains) and Northwest (support). A lack of gains or unfulfilled desires can lead to depression. Conversely, achieving gains and desires brings joy. Similarly, strong support from family and friends fosters a positive mindset, while its absence can cause depression. Therefore, balancing the energies in all directions is crucial for a happy and prosperous life.

North-West (NW): Banking and Support Systems

The North-West (NW) direction governs the entire support system in your life. Historically, it was used for storing essential food grains, ensuring availability when needed. In modern times, this translates to various forms of support, including financial aid from banks, raw material suppliers, labor, and buyers who keep money flowing within industries.

Crucially, the energies of the Northwest ensure you receive support precisely when it's most needed. Through various case studies, I've observed that issues like difficulty acquiring labor/staff or loan rejections from financial institutions often stem from the presence of toilets in the Northwest. Resolving these Vastu defects can completely resolve support-related problems.

When the Northwest direction has Vastu defects, your entire support system suffers, meaning you'll lack assistance from friends, family, customers, suppliers, and co-workers.

Conversely, a drawing room or meeting room in the Northwest can lead to favorable meeting outcomes and deals that align with your terms. A bedroom in this direction fosters a helpful nature in you, and ensures you receive support from others whenever required.

This direction is also ideal for placing a picture of your Kuldevta or Kuldevi (family deity). Just as Southwest governs ancestors and Northeast

governs deities, Northwest oversees your family deity, who provides all the support you receive in life.

The energies of the Northwest are a blend of WNW (detoxification) and NNW (attraction). By detoxifying negative past memories (WNW), you can live and enjoy your present. This, in turn, enables you to attract and connect with supportive individuals in your life (NNW) who will assist you whenever you need them.

North-North-West (NNW): Sex and Attraction

The North-North-West (NNW) direction, governed by Goddess Rati, is ideal for sexual pleasure and intimacy for married couples. Its energies draw attention to anything placed there, making it suitable for a marriageable child's bedroom to attract a life partner.

NNW influences both mind and body. Attraction originates in the mind, compelling the body to possess the desired object. This "force" is generated by NNW. Consequently, NNW is excellent for displaying sample racks or saleable products in shops or offices, as it draws customer attention and desire.

Composed of North-West (support/storage) and North (treasure/opportunities), NNW indicates that the quality of your stock and offerings determines customer attraction.

Avoid placing fire elements in NNW, as it will diminish attraction. Vastu defects here can cause marital problems due to unfulfilled sexual desires. When utilized wisely, NNW's energies bless individuals with all pleasures related to mind, body, and soul.

TOILET BLOCK BY METAL STRIP



TOILET BLOCK BY COLOUR/TAPE



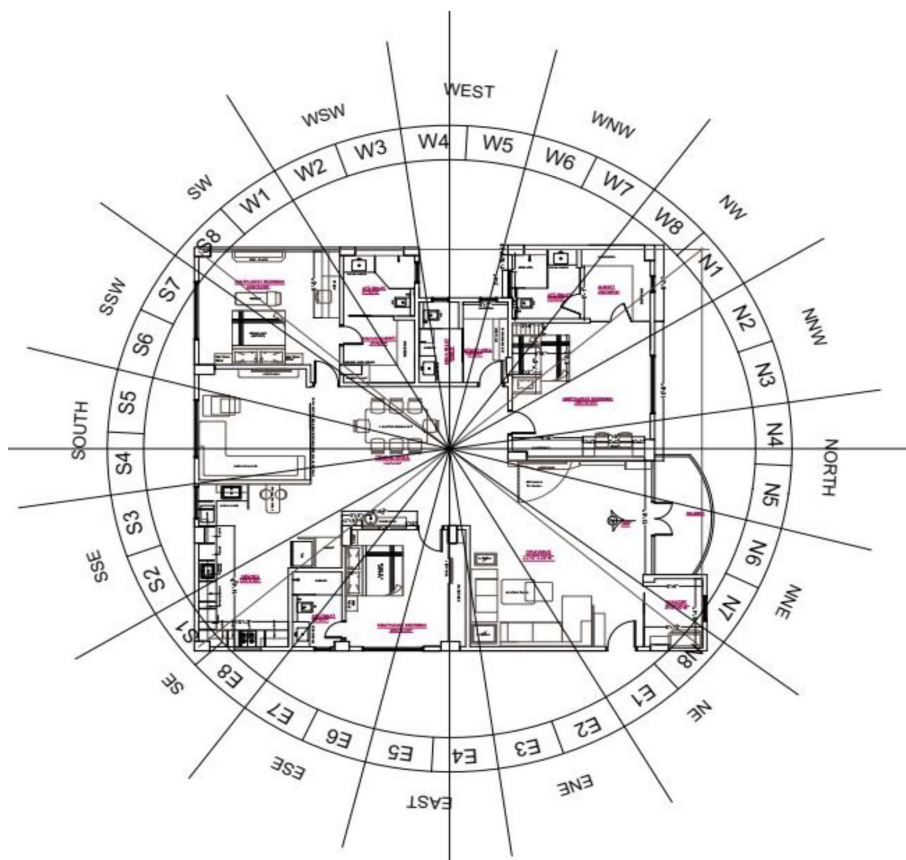

Chapter 4

Influence of the Five Elements and its Management Chart

The Five Elements (Panchtatva) in Vastu Shastra

The universe, including all forms of life, is composed of five fundamental elements: Air, Water, Fire, Space, and Earth, collectively known as Panchtatva. These elements form the bedrock of ancient sciences like astrology, Ayurveda, and Vastu Shastra.

In Vastu, the 16 directions of a space are intrinsically linked to these elements.

- Air element predominates from East-North-East to South-East.
- Fire element is prominent from South-East to South.
- Space element dominates from West-South-West to North-West.
- Water element is strong from North-North-West to North-East.
- Earth element is dominant from South-South-West to West.

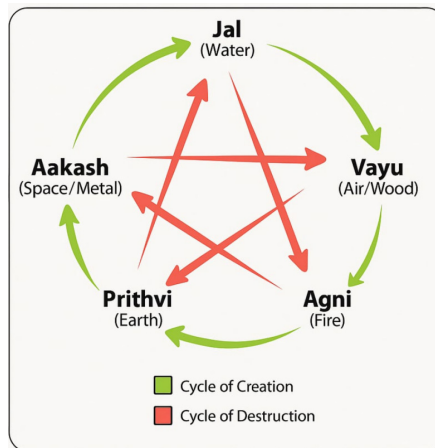

Additionally, cardinal directions are a blend of two elements:

- North-East combines major Earth with minor Water.
- South-East is a mix of Air and Fire.
- South-West comprises Earth and Space.
- North-West is composed of Space and Water.

Our ancient gurus, through 12,000 years of study, assigned these elements to specific directions. The buildings we inhabit are also manifestations of these five elements, with their proportions varying based on the area each direction occupies. For instance, a building on a North-South axis will have a greater prominence of Water and Fire elements due to larger North and South areas.

The dominant element in each direction influences the lives of its inhabitants. A balanced state of these elements leads to positive results, while an imbalanced state brings negative outcomes.

Vastu Shastra is a precise science, advocating belief only in what you can see, feel, or experience. To manifest desires, one must release past conditionings and experience life authentically, which initiates the creative process. Understanding the five elements is key to experiencing the world, as each element is associated with one of the five human senses (e.g., Water with taste, Air with touch). Balancing these elements within a building can even help control these senses.

The five elements operate in cycles of creation, destruction, and balance.

- **Creation Cycle:** Water fosters Air (plants), Air fuels Fire, Fire produces Earth (ashes), Earth creates Space (metals), and Space, when melted, forms Water.
- **Destruction Cycle:** Water extinguishes Fire, Fire destroys Space (melts metals), Space cuts Air (metal cuts wood), Air destroys Earth (trees break ground), and Earth blocks Water.

This continuous cycle governs creation and destruction throughout the universe. Understanding these detailed elemental relationships within directions is fundamental to applying Vastu principles effectively.

Water

The Water element in Vastu encompasses anything in a liquid state or anything that exhibits a flowing nature. Its associated color is blue, and its characteristic shape is wavy. Therefore, any object whose properties—including its shape, color, and inherent nature—align with these characteristics is considered an object of the Water element.

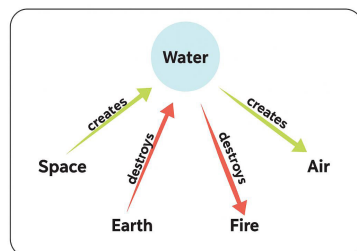

The Water Element in Vastu

The Water element is linked to the directions of North-North-West (attraction), North (opportunities), North-North-East (healing), and North-East (clarity).

A balanced Water element in a building bestows residents with appealing personalities, new financial opportunities, strong immunity, and clear insights for life's purpose and desires. Conversely, an imbalanced Water element leads to a lack of opportunities, weakened immunity, frequent illness, and a lack of clarity in life's direction.

In the elemental cycle, Water is the creator of Air (nurturing plants). It destroys Fire and is blocked by Earth. Water is created when metal is heated to a liquid state.

The inherent nature of Water is flow, encompassing mental thoughts, new opportunities, insights for growth, and positive energy for healing and immunity. Associated with the sense of taste, a balanced Water element is crucial for businesses in the food industry (restaurants, bakeries, etc.) to attract customers and ensure customer satisfaction, thereby facilitating growth.

Understanding the Air Element in Vastu

The Air element follows Water in the elemental sequence and is fundamental for life's survival. Its associated color is green, and its primary shape is a rectangle. Interestingly, an oval shape is also considered to embody the Air element, even if composed of water. This

is because when wavy (water) shapes gain edges, they transform into Air. Conversely, the sharp edges of a rectangle mark the initiation of the Fire element.

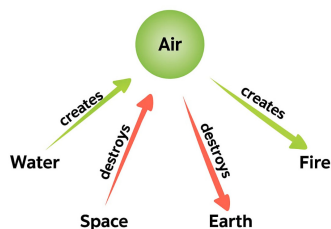

The Air Element in Vastu

The Air element is linked to East-North-East (joy/refreshment), East (social connections), and East-South-East (analysis/churning).

A balanced Air element grants the freedom to explore new avenues for growth, enables selection of beneficial insights, and fosters connections with supportive individuals. Conversely, an imbalanced Air element leads to feeling stuck, difficulty making decisions, and disputes with neighbors over minor issues.

Associated with the sense of hearing, a balanced Air element is crucial for those in the music industry or manufacturing hearing aids. Air's influence can transform, as seen in how rock music can energize, converting Air energy into Fire for relaxation or invigoration.

The Fire Element in Vastu

Following Air in the elemental sequence, Fire is the element that ignites life with spark and zeal. It's the source of money, security, confidence, peace, and relaxation, acting as the driving force behind all physical activities. The color associated with Fire is red, and its characteristic shape is a triangle.

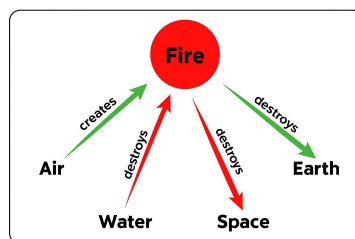

The Fire element is associated with the South-East (money), South-South-East (confidence), and South (peace) directions. A balanced Fire element brings abundant cash, unwavering confidence, and the ability to pursue goals with calmness and relaxation.

Conversely, an imbalanced Fire element leads to blocked payments, insecurity, departmental issues, lack of confidence and zeal, lethargy, and insomnia. It also creates obstacles in auspicious life events like marriage or childbirth and can cause stomach-related health problems.

Fire is linked to the sense of vision and holds a strong attractive quality, akin to Venus in astrology, whose gemstone is diamond. Industries where products sell based on their appearance—like jewelry, clothing, or interior design—greatly benefit from a balanced Fire element in their spaces. Finally, Fire creates the Earth element, as burning leaves behind ashes.

Earth

Following Fire, the Earth element signifies stability and anything stable or heavy. Its color is yellow, and its shape is square. Earth's "weight" can refer to physical objects or an individual's importance due to knowledge, skills, or social standing.

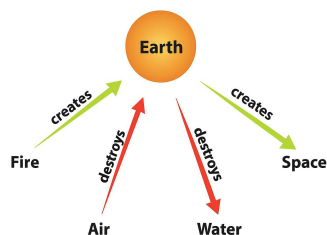

The Earth element manifests as stability in all aspects of life. Its dominance can even be observed in a person's speech, reflecting their core energetic balance (e.g., Amitabh Bachchan's grounded speech). By analyzing speech, you can identify your dominant element and energize its corresponding Vastu directions for better results.

The directions associated with Earth are South-West (skills and stability) and South-South-West (let go and expenditure). A balanced Earth element brings stability in career, business, and relationships, constant growth, and the ability to release negativity, turning expenses into investments. Conversely, an imbalanced Earth element causes insecurity in job and

relationships, frequent conflicts, and increased wasteful expenditure, leading to overall life instability.

Space

Following Earth, the Space element emerges directly from it. Its fundamental nature is expansion. Visually, the vast expanse of the sky embodies this element. In Vastu, the Space element grants expansion in all areas of your life, including career, financial gains, knowledge, and relationships. The colors associated with Space are grey or white, and its characteristic shape is a circle (round).

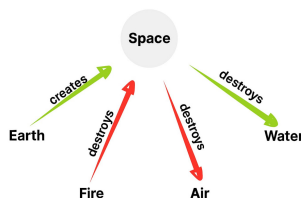

The Space element, originating from Mother Earth, is fundamental to manifesting desires and promoting expansion in all life domains. Vastu Shastra is precisely the science of defining areas within space to facilitate this manifestation.

The directions associated with Space are West-North-West (detoxification/ depression), West (gains/expansion), and North-West (support).

When Space is balanced in a building, residents experience emotional equilibrium, fulfilled desires, material gains, and consistent support in their career and home life. This fosters a winning attitude and drives business or career expansion.

Conversely, an imbalanced Space element leads to feelings of being stuck, depression, lack of material gains, and emotional and mental imbalance. To overcome these issues, balancing your space according to Vastu principles can unlock growth and prosperity.

Imbalanced Space

An imbalanced Space element obscures wisdom, making you feel your skills are lost and efforts unrewarded. If you're unable to effect positive change and constantly feel stuck and unclear, restoring balance and harmony to your space is crucial. This re-establishes the fundamental

connection to the Panchtatva (five elements) that create our physical reality, leading us to the Theory of Creation.

Theory of Creation

Water creates Wood: Wood creates Fire; Fire creates Earth; the Earth creates Space; and Space again creates Water.

To grasp the Theory of Creation, consider an internal cycle involving the five elements. We breathe, embodying the Air element. This fuels the internal Fire necessary for life, which then metabolizes food into energy, with waste disposal. The physical Fire, in turn, becomes Earth (ashes). From Earth comes Space (metals, equated with sky and mountains). When melted, Space transforms into Water, completing the cycle.

Alternatively, consider how Water descends from the sky, fostering Air (wood). Air then creates Fire, which forms Earth. Earth gives rise to mountains, which in turn lead to more water. Embrace this instinctive cycle without relying on strict logic, as it represents how the world is continuously created. Understanding this leads to examining the complementary aspect: the cycle of destruction or control.

Theory of Control

The control or alteration of our physical reality is also governed by the Five Elements. This dynamic interaction is known as the 'Cycle of Control'. By simply observing and reflecting on this cycle, you can grasp its complete order and understand how it influences our surroundings.

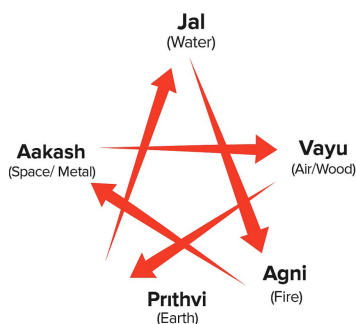

The Cycle of Control illustrates how elements manage each other: Water controls Fire, Fire controls Space (Metal), Metal cuts Wood, Wood separates Earth, and Earth blocks Water. This differs from the Cycle of Creation by focusing on suppression rather

than generation. In reality, creation and control occur simultaneously, reflecting life’s constant flux. Amidst these opposing forces, we exist in a continuous “Cycle of Balance,” representing our constant state of equilibrium.

Theory of Balance

When Creation and Control cycles combine, a dynamic balance emerges. Water creates Wood while controlling Fire. Air creates Fire while separating Earth. Fire melts Space and creates Earth. Earth blocks Water and creates Space, yet is separated by Wood. This constant interplay maintains equilibrium.

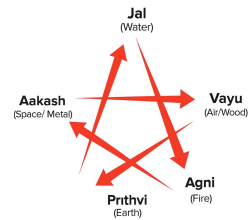

Every element, at any given moment, undergoes four simultaneous phases. Consider Water: it’s created by Space, in turn creating Air (wood). Simultaneously, it’s blocked by Earth and controls Fire. Understanding these parallel actions across all five elements clarifies how everything in life functions.

Colours Full of Life Force

Green, blue, and bluish-green are colors that stimulate the brain, enhancing positive thinking and creativity. When applied in the North-North-East (NNE) Vastu zone, they connect you to energies that inspire positive thoughts and fun. Used in the East-North-East (ENE) zone, these colors refresh both mind and soul, making them ideal for schools and businesses.

Below is a table summarizing the elements, their associated colors, shapes, and corresponding metals:

Conclusion

In Vastu, each direction is governed by a specific element: Water for North, Air for East, Fire for South, and Space for West, while Earth

governs the center. Imbalances occur when the wrong element is present in a particular direction.

For instance, placing Water features (like an underground tank or blue objects) in the South (Fire zone) weakens the Fire element, leading to issues like anxiety, fire accidents, restlessness, and disturbed sleep. Conversely, placing Fire elements in the North (Water zone) can block new opportunities, payment receipts, and orders. These examples demonstrate how elemental imbalances directly manifest as real-life problems.

Each element also has associated colors and shapes; for example, Fire is represented by red, orange, pink, and violet.

Simple Vastu Solutions: The Elemental Strip Technique for Entrances and Toilets

Many people avoid Vastu analysis fearing expensive demolitions. Traditionally, rectifying problematic entrances and toilets often required relocation. However, the Elemental Strip Technique offers a non-demolition solution. This effective Vastu remedy utilizes 3-4 inch wide colored strips, marked on the floor with paint or colored tapes, to correct elemental imbalances. This technique successfully neutralizes the negative effects of badly located entrances and toilets, providing an easy and practical alternative to costly structural changes.

Chapter 5

Vastu Flow Chart and Bar Chart

An accurate method of vastu evaluation

Vastu Procedure Flow Chart

Working with Vastu is a logical, step-by-step process. Focus on the symptoms and desired results rather than merely labeling a building as Vastu-faulty or compliant. “Symptoms” encompass both positive (e.g., abundance, job success) and negative (e.g., accidents, miscarriages) situations.

If symptoms perfectly align, desired results will manifest with equal precision. If there’s no match, re-check your scaled building plan and compass directions (allowing for a 2-3 degree deviation). If both are accurate, the problems likely aren’t Vastu-related. This scientific, clear procedure ensures consistent evaluations and actions among Vastu experts.

Finding Zonal Strength with Vastu Bar Chart Analysis

Vastu offers a scientific method to evaluate the strength of each Vastu zone within a building: the Vastu Bar Chart Analysis. This tool’s primary purpose is to assess the balanced and imbalanced states of zones, often caused by cuts or extensions in a building’s structure.

Modern architecture frequently features irregular shapes, especially in apartment buildings, making traditional Vastu application challenging. However, the Vastu Bar Chart Analysis enables highly accurate and precise Vastu application regardless of the floor plan’s shape. This

means that even with unconventional layouts, individuals can still benefit from Vastu principles and techniques.

Understanding the strengths and weaknesses of your living or working space is crucial for effective Vastu application, whether you're addressing problems or manifesting desired outcomes. The Bar Chart Analysis is particularly vital for sensitive techniques like Space Surgery and Space Extension. If applied incorrectly, these can have adverse effects, similar to surgery on a human body; however, when done correctly, they yield rapid results without demolishing the building.

The fundamental purposes of the Vastu Bar Chart are to:

- Identify cut and extended portions within a building.
- Recognize the zonal strength of each area to determine its balance.
- Identify zones that require extension, enhancement, exhaustion, or programming for desire manifestation.
- Confirm the symptoms reported by inhabitants or observed by the Vastu expert, ensuring an error-free analysis.
- Facilitate the selection of the most appropriate technique, color, shape, or metal to balance a specific zone.

The Bar Chart clearly illustrates which zones are exhausted (low energy) and which are extended (excessive energy). This provides a precise overview of the zonal balance in any building, regardless of its design.

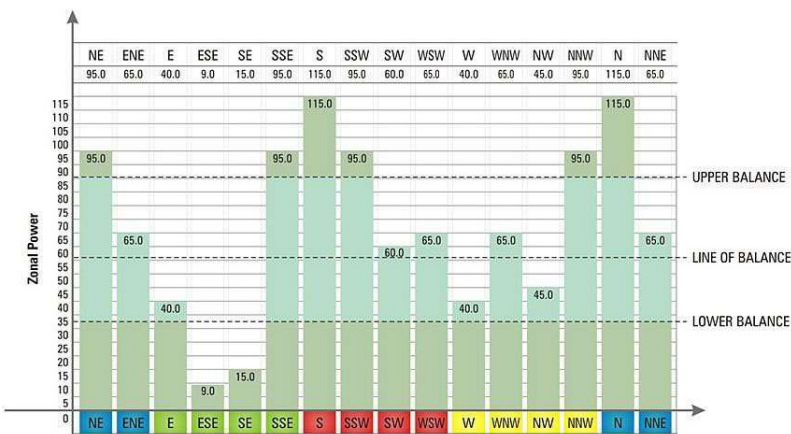

Chapter 6

Treating the Cut and Extended zones

Identifying and Treating Cut and Extended Zones with the Bar Chart

The Vastu Bar Chart is a visual tool that easily identifies a building's cut, extended, and balanced Vastu zones through varying bar heights and three horizontal balance lines (lower, proper, upper).

Here's how to interpret it:

1. **Extended Zone:** A bar higher than the upper balance line signifies an extended, imbalanced zone that needs to be exhausted to regain strength.
2. **Cut/Weak Zone:** A bar lower than the lower balance line indicates a cut or weak, imbalanced zone requiring extension or enhancement to strengthen it.
3. **Programming Zone:** Bars falling between the upper and lower balance lines represent balanced zones that need programming to achieve desired outcomes.

Both exhausting and enhancing Vastu zones are performed by applying the Theory of Five Elements.

Vastu Remedies for Cut and Extended Zones: A Comprehensive Guide

In Vastu, imbalances in a building's zones, whether due to a "cut" (weakness) or "extension" (excess), significantly impact the inhabitants'

lives. These can be rectified by applying specific elemental remedies, often involving colors, objects, or minor structural adjustments. The goal is always to restore balance and harmony.

North (N) - Water Element

- **Cut:** Inhabitants lack new opportunities and struggle to sell products/services.
 - **Treatment:** Use blue or white colors.
- **Extended:** Inhabitants receive new opportunities but fail to convert them.
 - **Treatment:** Use green color.

North-North-East (NNE) - Water Element

- **Cut:** Inhabitants experience low immunity, frequent illness, and difficulty concentrating.
 - **Treatment:** Apply blue or white colors.
- **Extended:** Inhabitants become excessively health-conscious, neglecting other life aspects.
 - **Treatment:** Use green color.

North-East (NE) - Water & Earth Elements (Cardinal)

- **Cut:** Inhabitants lack clarity and new insights for growth, hindering their thinking and ability to plan for future goals.
 - **Treatment:** Use off-white color or a pyramid to enhance positive energies.
- **Extended:** Inhabitants are overwhelmed by too many insights, leading to confusion in decision-making.
 - **Treatment:** Balance with off-white color or use metal strips to symbolically reduce the area.

East-North-East (ENE) - Air Element

- **Cut:** Inhabitants feel bored, suffocated, and lack joy/happiness, even with access to entertainment; they feel stuck.
 - **Treatment:** Apply blue or green colors.
- **Extended:** Inhabitants seek excessive enjoyment, harming professional life and diverting time to leisure.
 - **Treatment:** Use pink color (from the Fire element family), but avoid red.

East (E) - Air Element

- **Cut:** Inhabitants struggle to form or maintain beneficial social or client connections, often feeling exploited.
 - **Treatment:** Use blue or green colors.
- **Extended:** Inhabitants become overly involved in social matters, wasting time/energy without gains, hindering self-growth.
 - **Treatment:** Use red color.

East-South-East (ESE) - Air Element

- **Cut:** Inhabitants struggle to analyze options, leading to poor decisions, or over-analyze without reaching conclusions, causing delays and lack of growth.
 - **Treatment:** Use green color or a 0-watt Green Bulb.
- **Extended:** Inhabitants experience excessive churning and anxiety, pursuing too many ideas with no concrete results.
 - **Treatment:** Use off-white or the lightest shade of pink (mild fire, avoids boosting anxiety).

South-East (SE) - Fire Element

- **Cut:** Inhabitants face blocked payments, insecurity, frequent

accidents, skin problems, lethargy, and obstacles in auspicious events like marriage or childbirth.

- **Treatment:** Use red or green color, or light a 0-watt Red Bulb.
- **Extended:** Inhabitants become overly aggressive, causing client disputes; they prioritize money above all else.
 - **Treatment:** Use yellow color.

South-South-East (SSE) - Fire Element

- **Cut:** Inhabitants lack confidence and enthusiasm for risk-taking, feeling lethargic and easily tired.
 - **Treatment:** Use red or green color, or light a 0-watt Red Bulb.
- **Extended:** Inhabitants become over-confident, making risky decisions that may lead to losses. They feel energetic but quickly experience suppressed energy and lethargy.
 - **Treatment:** Use yellow color.

South (S) - Fire Element

- **Cut:** Inhabitants lack desired fame/recognition, receive no credit for efforts, and suffer from sleep disorders, insomnia, or restlessness.
 - **Treatment:** Use red or green color, or light a 0-watt Red Bulb.
- **Extended:** Inhabitants become slow and constantly sleepy even after adequate rest, lacking drive for growth. They perceive their fame as superficial, with others exploiting them.
 - **Treatment:** Use yellow color.

South-South-West (SSW) - Earth Element

- **Cut:** Inhabitants struggle to release negative energies or useless things, holding onto emotional stress and avoiding business investments.
 - **Treatment:** Use yellow color.

- **Extended:** Inhabitants face wasteful expenditure on useless items and may experience miscarriages.
 - **Treatment:** Use off-white color, and place a Yellow Brass Vase.

South-West (SW) - Earth Element

- **Cut:** Inhabitants experience unstable careers, relationship problems (due to unfulfilled expectations), lack skills to convert knowledge into gains, and face obstacles in marriage/childbirth.
 - **Treatment:** Use yellow color, or light a 0-watt Yellow Bulb.
- **Extended:** Inhabitants face relationship problems arising from over-expectations; professionally, they expect too much for their skills. Can also cause demanding family attitudes, impacting marriage.
 - **Treatment:** Use off-white color.

West-South-West (WSW) - Space Element

- **Cut:** Inhabitants lack proper knowledge to polish skills and have no monetary savings due to low gains and increased expenses.
 - **Treatment:** Use yellow or white color, or White plastic Pyramids.
- **Extended:** Inhabitants acquire useless knowledge, hindering skill application and leading them astray.
 - **Treatment:** Use blue color.

West (W) - Space Element

- **Cut:** Inhabitants struggle to acquire material gains and sufficient resources for desire fulfillment, including property acquisition.
 - **Treatment:** Use yellow or white color, or White plastic Pyramid.
- **Extended:** Inhabitants see gains coming but are unable to acquire them at the final stage; deals may be canceled last minute.
 - **Treatment:** Use blue color.

West-North-West (WNW) - Space Element

- **Cut:** Inhabitants feel useless and depressed, getting disturbed by minor life events.
 - **Treatment:** Use yellow or white color.
- **Extended:** Inhabitants carry excessive emotional stress, unable to release feelings, leading to depression.
 - **Treatment:** Use blue color.

North-West (NW) - Space, Earth, and Water Elements

- **Cut:** Inhabitants struggle to get desired support from family, friends, clients, banks, or financial institutions for loans/business expansion.
 - **Treatment:** Use off-white color, or place White Horses in the Northwest.
- **Extended:** Inhabitants either receive excessive support, making them dependent, or support is delayed when most needed. Also welcomes departmental problems.
 - **Treatment:** Use blue or off-white color.

North-North-West (NNW) - Water Element

- **Cut:** Inhabitants experience unsatisfactory sexual lives, lack intimacy, leading to irritation and arguments. Products/services lack attraction, resulting in low sales.
 - **Treatment:** Use blue or white color.
- **Extended:** Couples are physically/sexually unsatisfied, with an excessive urge for intimacy leading to irritation and fights. Products are attractive but perceived as too expensive, hindering sales.
 - **Treatment:** Use green color.

Programming Balanced Zones and Understanding Zonal Interplay

Once imbalanced zones are treated, balanced zones should be “programmed.” This involves placing specific objects and performing activities within these zones to generate desired subconscious emotions. For example, a toilet in the SE zone severely disrupts its balance; such forbidden activities must cease, replaced by conducive activities.

It’s crucial to understand that the total energy within an enclosed space is constant. An overactive zone depletes energy from others, leading to problems from both excessive and suppressed energies. For instance, while a balanced North (money flow) ensures smooth finances, an overactive North can make residents desperate for money. Similarly, a suppressed Southwest (relations) causes relationship issues, while an over-extended Southwest leads to demanding and possessive behaviors, exacerbating problems.



Chapter 7

Rooms Allocation as per Vastu

Every zone in your home holds specific energies. When rooms like kitchens, bedrooms, or even toilets are in suitable zones, they create opportunities. Conversely, an unsuitable placement can lead to significant obstacles, so strategic room placement is key to a beneficial home.

Ideal Zone for Puja Place/Puja Room

To connect with inner-self and Universal Consciousness, Hindu seers recognized that Devtas (Gods), representing various powers, are best worshipped in specific locations. They understood that natural elements like plants, stones, and rivers possess inherent Shakti (power). All of them can be broadly divided into 16 categories, as specified in the table below.

Vastu Zone	Ideal for Puja	Vastu Zone	Ideal for Puja
North	Goddess Lakshmi, Lord Ganesha	South	Maa Kali
NNE	Dhanwantri, Ashwini Kumar, Shiv Puja, Shiv Pariwar	SSW	Aghori
NE	Ideal for Puja	SW	Vishwakarma, Shastra, Pitra Puja
ENE	Radha-Krishna	WSW	Maa Saraswati

EAST	Ram Darbar, Lakshmi-Vishnu	WEST	Gurus/ Mother Earth
ESE	Charwak- Darshan	WNW	Yakshini Puja
SE	Maa Durga	NW	Pitra / Ancestor's rituals
SSE	Hanumanji	NNW	Sex puja, Tantrik

Ideal Puja Locations in Vastu Zones

Different Vastu zones are suited for specific types of worship, aligning with their inherent energies and resulting in beneficial outcomes.

- **NE (North-East):** The ideal zone for general puja and prayer, fostering mental clarity, divine guidance, and overall blessings for the building.
- **ENE (East-North-East):** While not for formal puja, this zone helps cope with stress, promoting freshness and renewed energy.
- **EAST (E):** Beneficial for politicians and bureaucrats, as puja here can secure favors from officials.
- **ESE (East-South-East):** Generally not recommended for puja, as it causes restlessness and anxiety. An exception is for stockbrokers, where it aids wise investments.
- **SE (South-East):** Only Ma Durga's puja is suitable. Other forms of worship can lead to accidents and fear of financial loss.
- **SSE (South-South-East):** Hanumanji's puja here grants power, strength, and confidence. Other pujas are less effective.
- **SOUTH (S):** Best for Ma Kali's puja and ideal for deep, relaxed meditation. Other pujas are ineffective.
- **SSW (South-South-West):** All pujas, except for Aghori-type practices, must be strictly avoided, as they invite losses.
- **SW (South-West):** Puja here can slow payment recoveries and hinder financial growth. Vishwakarma puja is an exception, enhancing workers' skills. Pitra puja (ancestral worship) is ideal.

- **WSW (West-South-West):** Only Maa Saraswati's worship is recommended for knowledge and wisdom. Other pujas should be avoided.
- **WEST (W):** Ideal for the worship of Gurus (past or present) and Mother Earth, bringing abundant financial gains. Other pujas should be avoided.
- **WNW (West-North-West):** Only Yakshini puja can be performed here. Other pujas should be avoided.
- **NW (North-West):** This zone is ideal for ancestral (Pitra) puja.
- **NNW (North-North-West):** Permissible for Sex puja, Panch Makar puja, and Tantrik puja, as Tantra rituals here can bring power and abundance. Other pujas should be avoided.
- **NORTH (N):** Ideal for Yaksha Sadhna, Lakshmi Pujan, and Ganesha puja. Other types of prayers should be avoided.
- **NNE (North-North-East):** The ideal zone for Shiv puja, Shiv Parivar, and Dhanwantri puja. Worship of the Ashwini Kumaras here also bestows health and vitality.

Bedroom Selection According to Vastu Zones

A bedroom is a vital space for physical and mental relaxation. Vastu dictates specific zones for different family members, but a universal rule applies: always sleep with your head pointing either South or East.

Effects of Bedroom Placement in Different Vastu Zones:

- **North-East (NE):** Strictly avoid a bedroom here. It causes irritability, disturbs the mind, and leads to gradual memory loss, even dementia. Remedial measures are ineffective; the space must be abandoned as a bedroom.
- **East-North-East (ENE):** A bedroom in this zone promotes joy, inner happiness, and a sense of purpose. It's ideal for older individuals as it discourages dwelling on the past.
- **East (E):** Sleeping here encourages socialization, helping individuals

emerge from their shells. This zone is highly beneficial for those aiming for a successful public life, especially in politics.

- **East-South-East (ESE):** A bedroom in this zone induces anxiety, causing over-analysis, difficulty letting go, disturbed relationships, and hypertension.
- **South-East (SE):** Being a Fire zone, a bedroom here makes individuals unnecessarily aggressive, short-tempered, and potentially increases their craving for money.
- **South-South-East (SSE):** This zone fosters great mental and physical strength. It's an excellent choice for a peaceful life and a relaxed, calm mind.
- **South (S):** A bedroom in the South zone ensures sound sleep.
- **South-South-West (SSW):** Immediately stop sleeping here. This zone is a frequent cause of feeling undervalued despite effort, insufficient returns, loss of vitality, and stomach-related health issues.
- **South-West (SW):** A bedroom here helps occupants regularly acquire and sharpen skills. It also promotes strong family bonds and care for loved ones.
- **West-South-West (WSW):** An excellent bedroom for share market enthusiasts willing to take risks.
- **West (W):** This is the zone of all-round gains. A bedroom here is beneficial for financial prosperity and gains in all aspects of life.
- **West-North-West (WNW):** Avoid a bedroom here. This zone is traditionally known as "Kop Bhavan," a place for retreat when annoyed, not for regular sleep.
- **North-West (NW):** A bedroom here cultivates excellent negotiation skills, making it highly beneficial for those needing bank loans, institutional funding, or financial backup.
- **North-North-West (NNW):** This zone is suitable for newly-wed couples or those soon to be married, promoting intimacy. However, children under 10-12 years should not regularly sleep here.

- **North (N):** A bedroom in the North zone is a great boon for career growth. Occupants consistently find work, and even lazy individuals can earn well. Minor sleep-related problems may occur.
- **North-North-East (NNE):** Vastu permits a bedroom here with caution: it can weaken the immune system and cause cough problems. However, it can provide temporary relief for sick individuals.

Optimal Drawing Room Placement for Desired Social and Business Results

The location of your drawing room significantly impacts social and business interactions, as it's primarily where less intimate visitors are entertained.

Here's how a drawing room in each of the 16 Vastu zones can affect these relationships:

- **North-East (NE):** Discussions lean towards religious matters, fostering connections with spiritual individuals.
- **East-North-East (ENE):** Ensures guests are well-entertained, and family gatherings are enjoyable.
- **East (E):** The perfect zone for a drawing room. Meetings here lead to lasting social bonds and mutual understanding.
- **East-South-East (ESE):** Meetings are often fruitless and lack conclusion, due to its "churning" energy.
- **South-East (SE):** Discussions yield positive results but tend to be far from peaceful.
- **South-South-East (SSE):** Meetings are characterized by agreements, peace, and graceful discussions.
- **South (S):** Facilitates more relaxed meetings.
- **South-South-West (SSW):** Being the "Zone of Disposal," a drawing room here will lead to financial losses.
- **South-West (SW):** Discussions will focus on family matters, relationships, ancestors, and overall life stability.

- **West-South-West (WSW):** Conversations will revolve around children's education and government-related issues.
- **West (W):** Meetings in this zone are highly productive and fruitful.
- **West-North-West (WNW):** Such drawing rooms become venues for catharsis, where inhabitants express their problems and difficulties.
- **North-West (NW):** Meetings involving negotiations are favorable for the inhabitants, making it hard for visitors to refuse requests for help.
- **North-North-West (NNW):** Occupants tend to meet and help others without personal monetary gain, finding pleasure in discussing chosen topics.
- **North (N):** Discussions spontaneously generate new money-making opportunities and possibilities, leveraging everyone's skills.
- **North-North-East (NNE):** Visitors offer tips for better health. However, sofa colors should be carefully chosen, as anti-colors (like red) can adversely affect health.

Optimizing Your Dining Place According to Vastu

A dining hall is where you receive, eat, and enjoy food, making its location crucial for digestion and meal enjoyment. It also symbolizes fulfilled desires and feedback for improvement.

The ideal Vastu zones for dining are West, North, East, South, South-South-East, and North-North-East, all yielding positive effects.

Effects of Dining in Different Vastu Zones:

- **North-East (NE):** Dining here cultivates a religious mindset. People may prefer liquids, fast often, and prioritize food based on religious prescriptions, often leading to avoidance of onion and garlic.
- **East-North-East (ENE):** People focus more on the ambience and presentation of food than its quality or nutrition. Children may develop a preference for junk food, while older people become more inclined towards Ayurvedic and herbal diets.

- **East (E):** This zone encourages social gatherings. Individuals dining here are inclined to invite friends and acquaintances to share meals, fostering social connections.
- **East-South-East (ESE):** Dining here causes anxiety and irritability. Individuals may complain about food quality, constantly analyzing its taste, nature, and health effects.
- **South-East (SE):** A dining hall here acts as an appetizer, improves digestion, and encourages timely meals, but can make the person more aggressive.
- **South-South-East (SSE):** Food eaten here is easily digested, provides essential nutrients and strength, and has a healing effect on the body.
- **South (S):** Another good zone for dining. Food digests properly, and people feel relaxed, at home, and experience peace of mind.
- **South-South-West (SSW):** Family members may be reluctant to use this area. Food consumed here offers no strength or nutrition, and regular use can lead to health problems.
- **South-West (SW):** Dining here fosters disharmony, dissatisfaction, and relationship problems within the family, leading to arguments.
- **West-South-West (WSW):** People become highly conscious of proper eating etiquette and table manners, such as using cutlery or chopsticks.
- **West (W):** This zone fulfills the purpose of dining. Food consumed here results in net gains, proper nutrient absorption, and good health.
- **West-North-West (WNW):** People dining here may complain constantly about the food or its perceived ill-effects. Prolonged use can lead to a negative attitude.
- **North-West (NW):** With a dining table here, people receive support and help when needed, leading to the fulfillment of desires.
- **North-North-West (NNW):** Dining here acts as an appetizer

and activates taste buds, encouraging a love for new and diverse culinary experiences.

- **North (N):** Dining in this zone makes you more conscious of career growth. Regular meals here can sharpen career vision, increase focus, and help overcome life's challenges, though digestion might be slightly poor.
- **North-North-East (NNE):** Dining here promotes good health. Individuals become more health-conscious and mindful of their diet.

The Importance of Storeroom Placement in Vastu

The storeroom, often underestimated, represents the Earth element and is meant for keeping items not currently in use. Its placement significantly influences the home's energy and the inhabitants' well-being, producing diverse emotional and practical effects depending on the Vastu zone.

Effects of Storeroom Placement in Different Vastu Zones:

- **North-East (NE):** This zone is for clarity and should be free of anti-elements. A storeroom here is a strict no, as it can lead to mental blockages, dilemmas, and indecisiveness, negatively impacting personality.
- **East-North-East (ENE):** A storeroom here can induce lethargy, a pleasure in collecting useless items, procrastination, and a detachment from celebrations, hindering the enjoyment of life.
- **East (E):** A storeroom in this zone hampers social connectivity, making inhabitants undervalue external relations or struggle to form them despite effort.
- **East-South-East (ESE):** This is a suitable location for a storeroom, as it helps reduce anxiety and unwanted, tension-causing thoughts.
- **South-East (SE):** A storeroom here slows down the inflow of money and business expansion, making it difficult to recover funds. Inhabitants may become overly frugal. For those in the service sector, however, it can help secure jobs.

- **South-South-East (SSE):** A storeroom in this zone is good, providing feelings of power, confidence, and security.
- **South (S):** A storeroom here relaxes the mind and removes unwanted fears. It also signifies power derived from past-earned relationships.
- **South-West (SW):** A storeroom can be placed here, but it must be kept free from all clutter.
- **South-South-West (SSW):** Ideal for storing waste or disposable items. However, valuable goods should not be stored here.
- **West-South-West (WSW):** A very good location for a storeroom. It helps build a strong foundation of cultural values (Sanskar) in children and improves their concentration in studies. Only useful articles, not junk, should be stored here.
- **West (W):** A storeroom here brings secured gains to occupants. However, storing junk will convert these gains into junk. Therefore, it's ideal for iron safes or other important goods.
- **West-North-West (WNW):** A storeroom here provides inner confidence, blocks low moods, and empowers the mind to face adverse emotional states, making it a good place for a storeroom.
- **North-West (NW):** An ideal place for a storeroom, suitable for any kind of goods. It secures bank positions for occupants and attracts helpful people, enhancing banking and social support.
- **North-North-West (NNW):** A storeroom in this zone can reduce interest in sex. While an organized store is less problematic, storing junk here can increase female residents seeking male companionship outside the home.
- **North (N):** Not advisable for a storeroom. Storing various articles (especially with different metals and shapes) can hamper career growth and money inflow.
- **North-North-East (NNE):** A storeroom in this zone can adversely affect the inhabitants' health, and thus should be avoided.

Kitchen Design: Optimal Zones and Their Effects

A kitchen, a “Fire” activity, provides nourishment, making its placement critical. The South-South-East (SSE) is considered the ideal zone for a kitchen.

Effects of Kitchen Placement in Different Vastu Zones:

- **North-East (NE):** Leads to severe brain ailments, confusion, and lack of mental clarity.
- **East-North-East (ENE):** Causes inhabitants to crave fun they can't attain due to the zone's fire energy.
- **East (E):** Gives average results for money and social connectivity; good for religious buildings.
- **East-South-East (ESE):** Results in continuous family clashes; males may develop diabetes and hypertension.
- **South-East (SE):** Improves cash flow and zeal, increases aggression, but helps recover blocked payments.
- **South-South-East (SSE):** The ideal zone. Provides strength and confidence, and the food cooked here is delicious and healthy.
- **South (S):** Brings fame and recognition, promoting a relaxed and comfortable life.
- **South-South-West (SSW):** Causes severe clashes between father and son, increases expenditures, and poses health hazards.
- **South-West (SW):** Occupants struggle to utilize skills, leading to career instability and poor home relationships; children's marriages may be delayed.
- **West-South-West (WSW):** Adversely affects savings; children may struggle academically despite efforts.
- **West (W):** Not ideal; food cooked here reduces business profit margins.
- **West-North-West (WNW):** The wife may frequently complain about her husband's habits, but otherwise, it's considered good for the family.

- **North-West (NW):** Hampers support for residents.
- **North-North-West (NNW):** Disturbs intimate relations between spouses.
- **North (N):** Hampers career growth and opportunities; sales plummet, and food cooked here tastes poor.
- **North-North-East (NNE):** Severely affects residents' health, leading to ailments and requiring regular medication.

A kitchen, representing the Fire element and symbolizing nourishment, is crucial. The South-South-East (SSE) is considered the ideal zone for its placement.

Here's how kitchen placement impacts different Vastu zones:

- **NE:** Leads to brain-related ailments and confusion.
- **ENE:** Causes a desperate craving for fun, which remains unfulfilled.
- **EAST:** Provides average financial and social results; good for religious structures.
- **ESE:** Triggers continuous family clashes, potentially leading to diabetes and hypertension in males.
- **SE:** Improves cash flow and zeal, increases aggression, but aids in recovering blocked payments.
- **SSE:** Ideal zone; provides strength, confidence, and ensures delicious, healthy food.
- **South:** Brings fame and recognition, fostering a relaxed and comfortable life.
- **SSW:** Causes severe father-son clashes, increased expenditures, and health hazards.
- **SW:** Hinders skill utilization, leading to career instability, poor relationships, and delayed marriages for children.
- **WSW:** Adversely affects savings; children struggle academically.

- **WEST:** Not ideal; reduces business profit margins.
- **WNW:** Wife may complain about husband's habits, but otherwise beneficial.
- **NW:** Hampers support for residents.
- **NNW:** Disturbs intimate marital relations.
- **NORTH:** Hinders career growth and opportunities; sales plummet, and food tastes poor.
- **NNE:** Adversely affects residents' health, leading to frequent ailments and medication.

Chapter 8

Interior Object Allocation as per Vastu

The placement of interior objects, each symbolic of elements and emotions, significantly impacts a built space. Understanding these effects is crucial, especially for commonly used items like the television, a popular medium for entertainment, stress relief, and knowledge gain. Its Vastu zone placement creates distinct outcomes:

- **North-East (NE):** Encourages intellectualizing meditation rather than practicing it, seeking clarity on the subject.
- **East-North-East (ENE):** The ideal zone for a TV, filling the atmosphere with fun, energy, and maximum enjoyment.
- **East (E):** Enhances social connectivity and viewer awareness; news channels are preferred. Especially good for politicians.
- **East-South-East (ESE):** Helps overcome stress and anxiety; viewers prefer informational channels like Discovery or History to find solutions.
- **South-East (SE):** Interests viewers in financial programs and thrillers, like crime shows and action movies.
- **South-South-East (SSE):** People prefer watching programs related to physical strength, such as aerobics, yoga, and nutrition, aiming for power and health.
- **South (S):** Watching TV here promotes complete relaxation and sound sleep.
- **South-South-West (SSW):** Leads to a complete waste of time and resources. Decisions based on TV information (e.g., share market) result in losses. The TV itself may require frequent repairs.

- **South-West (SW):** Functions as a skill enhancer; viewers enjoy programs that augment their skill sets.
- **West-South-West (WSW):** Hampers children's study and concentration, diverting them to cartoons, though it can be used for educational programs.
- **West (W):** Viewers gain useful information from programs; particularly beneficial for those in trading.
- **West-North-West (WNW):** Causes depression and low moods; people become emotional and may cry while watching.
- **North-West (NW):** Naturally develops the capacity to attract support for causes when needed.
- **North-North-West (NNW):** Associated with watching adult programs and pornography, potentially leading to mimicking observed behaviors.
- **North (N):** Provides a clearer career vision; individuals seek new avenues and watch career-oriented programs.
- **North-North-East (NNE):** Viewers become overly health-conscious from watching health channels, paradoxically leading to poor health and low immunity.

Computer Placement Based on Purpose in Vastu

A computer serves diverse purposes, from education and information gathering to entertainment. Its Vastu placement, therefore, should align with its primary use to optimize benefits and prevent issues like excessive or inappropriate usage.

Here are the effects of placing a computer in different Vastu zones:

- **North-East (NE):** Ideal for religious site surfing, creativity, and generating new ideas.
- **East-North-East (ENE):** Best for gaming, music, and general fun or enjoyment.

- **East (E):** Suited for connecting with the world and staying updated on local events.
- **East-South-East (ESE):** Excellent for data entry, complex calculations, and research and development work.
- **South-East (SE):** Ideal for maintaining healthy cash balances.
- **South-South-East (SSE):** Enables long working hours without fatigue.
- **South (S):** Any work done here will bring admiration and fame.
- **South-South-West (SSW):** Computer use will be infrequent, require frequent repairs, and lead to losses, especially for those in shares and trading.
- **South-West (SW):** Ideal for skill-based work like designing, enhancing skills and yielding better results.
- **West-South-West (WSW):** Good for gaining knowledge; children can use it for educational purposes, particularly beneficial for accountancy.
- **West (W):** Information gained here is highly beneficial, especially for those in the share market.
- **West-North-West (WNW):** Best utilized for countering low moods, stress, and depression.
- **North-West (NW):** Proves helpful when needed, providing timely support from contacts.
- **North-North-West (NNW):** Avoid placing a computer here, as it's prone to being used for pornography and seeking pleasure, especially for growing children.
- **North (N):** Best for career-related purposes and seeking new opportunities.
- **North-North-East (NNE):** Can be placed here for obtaining vital health information.

Ideal Washing Machine Placement According to Vastu

A washing machine, an activity of “churning,” is intrinsically linked to the East-South-East (ESE) Vastu zone, which governs anxiety and analysis. Its placement significantly impacts the inhabitants’ mental state and daily life.

Effects of Washing Machine Placement in Different Vastu Zones:

- **North-East (NE):** Leads to meaningless over-analysis, anxiety, headaches, and a mind cluttered with useless thoughts.
- **East-North-East (ENE):** Causes individuals to be constantly preoccupied, even during pleasurable activities.
- **East (E):** Makes people overly concerned with their social status, public image, and others’ opinions.
- **East-South-East (ESE):** This is the ideal zone. It reduces unnecessary mental churning, promoting a calm and peaceful atmosphere.
- **South-East (SE):** Causes the person to constantly think about cash and making more money.
- **South-South-East (SSE):** Makes the person more concerned about healing, general health, strength, and self-confidence.
- **South (S):** Hampers residents’ sound sleep, leading to constant analysis and anxiety even in bed.
- **South-South-West (SSW):** Individuals waste time analyzing trivial matters, leading to losses in decisions. The washing machine will also require frequent repairs.
- **South-West (SW):** Increases mental churning about family relations, leading to differences of opinion among family members.
- **West-South-West (WSW):** Creates an overly cautious attitude in residents (especially children), increasing the time taken to complete tasks.
- **West (W):** Causes a desperate craving for gains that do not materialize.

- **West-North-West (WNW):** This is an ideal place. It cleans clothes while clearing mental clutter and emotional blockages.
- **North-West (NW):** Leads to positive interactions with supportive people and bank officials.
- **North-North-West (NNW):** Causes constant thoughts about physical relations, often disturbing husband-wife relationships.
- **North (N):** Occupants will constantly ponder their career, whether to continue or change jobs.
- **North-North-East (NNE):** Makes a person fussy about food and its health effects, ultimately leading to poor health.

Ideal Locker Placement in Vastu

The most auspicious place for a safe or locker is the North, where Lord Kubera, the God of Wealth, resides. The locker should not face East.

Lockers are primarily of two types:

1. **For long-term storage of valuables:** An iron locker is advised in the West or West-South-West (WSW) zone, painted cream. This placement enhances gains, profits, and rewards for efforts. Auspicious locker sizes are 6.5-10 inches or 15-19 inches. This is a beneficial remedy for those struggling with savings.
2. **For daily use:** This locker, made of wood or iron, should be kept in the North. When sized correctly, it is highly profitable.

Key considerations for all lockers:

- Never keep a locker empty.
- Always place a picture of Goddess Lakshmi and Lord Ganesha, or five to seven silver coins, inside.
- In the South-West (SW) or West-South-West (WSW) zones, avoid placing the locker under the floor. If a locker cannot be placed there, a cream-colored piggy bank with coins can serve as a remedy.

Account books, symbolizing collected valuables, should be red (other writing books, khaki). Keep them in a cupboard that opens towards the North, but the cupboard itself should be placed in the South-West (SW) or West-South-West (WSW) zone. Regularly checking accounts every Tuesday and Saturday is also recommended, as this practice increases wealth.

Where to Place an Air Conditioner

An Air Conditioner (AC), associated with both Air and Fire elements, influences a home's energy. Its placement in different Vastu zones can have varied effects on inhabitants.

Zones Effect:

- **North-East (NE):** Not a good location; causes anxiety and mental instability.
- **East-North-East (ENE):** Permissible.
- **East (E):** Permissible; no negative effects.
- **East-South-East (ESE):** Permissible.
- **South-East (SE):** Avoid here; causes cash liquidity problems and hampers savings.
- **South-South-East (SSE):** Permissible; no negative effects.
- **South (S):** Permissible (due to Fire element association).
- **South-South-West (SSW):** Permissible.
- **South-West (SW):** Not a good location; residents crave comfort at work.
- **West-South-West (WSW):** Permissible; no negative effects.
- **West (W):** Permissible; no negative effects.
- **West-North-West (WNW):** Permissible; no negative effects.
- **North-West (NW):** Permissible.
- **North-North-West (NNW):** Permissible; no negative effects.

- **North (N):** Permissible; no negative effects.
- **North-North-East (NNE):** Permissible; no negative effects.

In essence, most zones are permissible for an AC, with North-East (NE), South-East (SE), and South-West (SW) being the key areas to avoid due to potential negative impacts on well-being and finances.

Optimal Study Table Placement for Academic Success

Choosing the right Vastu zone for a study table is crucial, especially for children. It can significantly impact their concentration, academic performance, and even their preferred subjects.

Here's a breakdown of how different Vastu zones influence studies:

- **North-East (NE):** Excellent for research; fosters new ideas and insights for academic excellence.
- **East-North-East (ENE):** Children may feel burdened by studies and prefer to use the table for leisure (e.g., reading comics).
- **East (E):** Students will gravitate towards studying political science.
- **East-South-East (ESE):** Students become over-analytical, hindering their grasping power.
- **South-East (SE):** Ideal for studying Crime or Law.
- **South-South-East (SSE):** Children will show more interest in sports, yoga, or physical education.
- **South (S):** Makes children sleepy and too relaxed to focus on studies.
- **South-South-West (SSW):** All studies here will fail, leading to poor grades or failure. Children will be reluctant to use this table.
- **South-West (SW):** Successful for studies related to skills like Architecture or music.

- **West-South-West (WSW):** The ideal zone for school students; promotes natural inclination towards studies and excellent grades.
 - **West (W):** Students gain from all efforts, especially beneficial for Accountancy.
 - **West-North-West (WNW):** Avoid placing a study table here as it causes stress, depression, and low moods.
 - **North-West (NW):** Good for studying retail chains and general administration, particularly beneficial for Home Science and Inventory Management.
3. **North-North-West (NNW):** Students will focus on useless matters (movies, TV) instead of concentrating on studies.
- **North (N):** Makes children career-oriented, ideal for professional studies like MBA or IAS.
 - **North-North-East (NNE):** Children will prefer to study Medical Science, Ayurveda, or Alternative Medicine.

Using Paintings & Photographs for Desired Outcomes in Vastu

Vastu offers an innovative technique to manifest desires: placing specific paintings or photographs in relevant zones. Select an image that precisely depicts your desired outcome and position it in the corresponding Vastu zone. For instance, to deepen meditation, place a picture of Lord Buddha in the North-East. For career growth, hang an image of greenery in the North. Similarly, a happy family or couple photograph in the South-West can significantly improve relationships and marital bliss.

Chapter 9

Tri Doshas and Remedies Vata, Pitta & Kapha

Vata is constituted by space and air, which is the energy of the movement.

Pitta is constituted by fire and water, which is the principle of digestion and metabolism.

Kapha is constituted by water and earth, which is the principle of structure and lubrication.

Unhealthy diet, repressed emotions, and lack of exercise disrupt one's dosha balance. Health signifies order and balance, while disease indicates disorder and imbalance. Though everyone possesses all three doshas, typically one is primary, another secondary, and the third least prominent.

Vata, the primary Ayurvedic principle, governs all mental and physiological activities, including breathing and heartbeats. Balanced Vata is lively; imbalance can cause dry skin/hair and cough, requiring rest.

Pitta, the fire element, regulates body temperature, digestion, and metabolism, promoting vitality. Prominent Pitta individuals are strong-willed leaders. Imbalance leads to anger, ulcers, and inflammation, relieved by cooling scents and massages.

Kapha maintains body resistance, associated with thoughtful, calm individuals. It's responsible for body building, growth, and cell creation. Balancing Kapha involves gentle exercise, stimulating activities, and increased fluid intake.

Know what your prominent dosha is?

Each person possesses a unique combination of three doshas (Vata, Pitta, Kapha) that shape their inherent physical and personality traits. These can shift with physical, mental, and emotional states. Understanding your prominent dosha, and tailoring your lifestyle accordingly, is key to balance and well-being. There are seven body types, each with advantages and disadvantages.

How to Balance Kapha?

To balance Kapha, focus on a light, low-fat diet with bitter, pungent, and astringent tastes. Include raw vegetables, ripe fruits, rye, oats, millet, barley, honey, and spices like pepper, cardamom, cloves, mustard, and turmeric. Limit fats, milk, and rice.

How to Balance Vata?

For Vata balance, emphasize sweet, salty, sour, warm, and easily digestible foods. This includes vegetables like broccoli, leafy greens, cauliflower, wheat, rice, mild spices (cumin, ginger, cinnamon), moist foods (berries, melons, yogurt), and oily foods (avocado, buttermilk, cheese, whole milk, eggs, coconut, nuts, seeds). Avoid excessive spicy and astringent foods.

How to Balance Pitta?

To balance Pitta, avoid alcohol, spicy, oily, fried, salty, and fermented foods, as well as acidic and hot items. Opt for sweet, bitter, and astringent tastes, incorporating sweet fruits, dairy, curry leaves, barley, oats, and mint. Steer clear of sour fruits, red meat, potatoes, and tomatoes.

What to eat to balance your dosha?

Dosha can be balanced through herbal remedies, warm oil massages, yoga, and a suitable diet.

Chapter 10

Industrial Vastu

Applying Vastu Shastra principles to factory construction, regardless of size or name (Mill, Plant, etc.), is crucial for preventing administrative, financial, and labor issues. Building a factory with Vastu in mind can significantly protect an entrepreneur's finances and reduce future headaches.

Every industry is unique, with varying priorities; for example, taste is paramount in the food industry, design in personal accessories, and composition quality in pharmaceuticals. Consequently, Vastu solutions must be customized to address these specific needs and priorities.

It's common to see similar industrial units experience vastly different outcomes – some flourish, while others struggle. While blame often falls on "luck," the underlying structure and placement within the factory, guided by Vastu, often play a significant role. Adhering to Vastu Shastra during construction brings peace and prosperity, whereas ignoring these tenets can lead to troubles. Understanding the scientific concepts of Vastu and applying them is essential to reaping its benefits.

Business owners and industrialists increasingly recognize Vastu Shastra as a key to unlocking peace and prosperity. The demand for industrial Vastu has surged with globalization and economic growth, as many attribute production or labor challenges to a reluctance in following its principles.

Here’s an image which indicates the ideal vastu for factory layout

Finished goods, guard room, labour quarter, labour toilet, generator, parking	Account office, reception, open area, lawn, parking, liquid storage, fountain area	Laboratory, open area, research/development, boring, mandir, underground water tank
Owner office, raw material, staircase, machinery		Administrative office, lawn area, open area, garden, parking
	Main office,	Boilers, furnace,
Operator’s office,	Machinery,	Electrical equipments,
Machinery	Transformer,	Guard room, labour
	Pantry	Quarter, labour toilet

Selection of Land/ Plot as per Vastu

For any land acquisition, especially industrial, prioritize a square or rectangular plot with equal corners. A beneficial exception is an outward projection with an increased slant in the Northeast corner.

Factory plot directions influence success:

- **East-facing:** Ideal for paper, cloth, limestone, and white substance industries.
- **North-facing:** Benefits ice and pulse industries.
- **South-facing:** Favorable for engineering, steel, iron, tobacco, black plastic, coal, oil mills, jewelry, cosmetics, electrical goods, hotels, and hospitals.
- **West-facing:** Suits general provisions, gram/wheat flour, automobiles, and transport.

Office internal arrangement: Seating should be in the Southwest, facing North or East. Accounts and computers should face North, placed in the Southeast, East, or North regions. Office doors are best in the Northeast, Southeast, or Northwest.

Why is vastu for factory shed important?

Vastu for a factory shed is crucial because it helps achieve maximum production with minimal effort by ensuring all processes are in sync. Since every industry has unique products and processes, Vastu principles must be customized for each.

For instance, a food industry prioritizes taste, while a luxury watch industry focuses on design. Vastu accounts for these unique requirements. For a steel factory, the Southeast (fire zone) is critical for heating and melting processes. Conversely, a medicine manufacturing unit needs defect-free West and South zones to ensure quality.

Therefore, whether it's a large or small factory, adhering to Vastu principles for shed construction, stairs, water bodies, machinery placement, goods movement, and even the office and main gate, is vital for success.

Slope of land in and around the industrial shed

Vastu for industrial construction places strong emphasis on land slope. The ideal industrial plot slopes downwards towards the North or North-East, as this aligns with the Earth's magnetic field flow from North-East to South-West, maximizing positive energy. Conversely, a slope towards the South or South-West is highly inadvisable, as it enhances negative energy.

Similarly, within the industrial shed, the roof should slope towards the North or East for rainwater runoff. Proper slope ensures beneficial energy flow, while slopes towards the South and West can lead to negative influences and harm.

Vastu for Factory Machines: Correct directions and placements

Contrary to popular myth, placing all factory machinery only in the southwest corner is incorrect. Vastu for factory machines emphasizes that placement should be based on the machine's activity, not its weight. Each industry and machine is unique. For instance, a stone crushing

machine is best in the northwest corner, aligning with the “Rudra” energy field that governs crushing. Therefore, defining the machine’s purpose is crucial for correct Vastu placement.

Vastu for Factory Office, Staff, and Labor

Proper Vastu for a factory office, staff cabins, and labor quarters is crucial for operational success. The placement should align with the functions performed.

Owner’s Office:

- **West:** Ideal for overall gains and profits.
- **South:** Brings name, fame, and an authoritative position.

Labor Quarters:

- Best in the Southeast corner of the shed, as its fiery energy keeps labor motivated and energized.

Staff Cabins based on duties:

- **Technical machine operators:** Their cabin should be in the Southwest to enhance skill development.
- **Administrative area:** Ideally located in the East, aligning with the sun’s energy for control and administration skills.

Guard Room:

- The South of South-East is the ideal location for the guard room.

Vastu for Raw Materials and Finished Goods

Correct placement of raw materials and finished goods is vital for a factory’s survival. Raw materials are best kept in the West zone. If raw materials are mostly liquids, they can be placed in the North or North-East.

For finished goods, North-West is the ideal direction. This “Vayavya

Koan" zone, governed by the Vayu (air) element, ensures their continuous movement and flow, promoting steady dispatch and sales.

Parking area for vehicles as per industrial vastu

As per industrial Vastu, segregate parking for heavy and light vehicles. Heavy vehicles should park outside; if inside, use the South and South-West zones.

Lighter vehicles (scooters, bicycles) are best parked in the North-West, North, or East zones. Crucially, avoid any parking in the North-East due to its sensitive energy. This strategic placement optimizes flow and harmony within the industrial premises.

Kitchen and pantry placement

For factory kitchens or pantries, which embody cosmic fire, the South East to South directions are ideal for placement to ensure the fire element is balanced. Avoid black or blue paints, granite slabs, or tiles in the kitchen, as these water elements contradict fire.

Direction wise effects of water tank, open well or tube well etc.

- **North East & North:** Bring happiness and prosperity.
- **East:** Grants fame.
- **West:** Offers temporary monetary gains.
- **South East:** Problematic for children's progress.
- **South:** Creates problems for females.
- **South West:** Leads to monetary loss.
- **North West:** Invites enmity and theft.
- **Centre:** Results in total destruction.

Ideal Factory Design as per Vastu

For optimal factory operations and prosperity, Vastu Shastra offers key guidelines:

1. **Main Entrance:** Position in the North, East, or Northeast with a larger door for excellent profits.
2. **Finished Goods Exit:** Products should leave through a door in the Northwest for quicker disposal and higher profits.
3. **Compound Areas:** The South and West areas of the compound should never be empty.
4. **Heat-Generating Equipment:** Energy meters, furnaces, transformers, generators, and boilers must be in the South-East for smooth operations.
5. **Storeroom:** Locate in the South or West, potentially extending towards the West, to assist continuous goods flow.
6. **Northeast Zone:** This area, both inside and outside the premises, must be kept very clean, open, or empty.
7. **Office:** Situated in the North or East. Owners should face North or East during business deals for greater benefit.
8. **Heavy Machinery:** Place in the South, South-West, and West areas of the factory.
9. **Toilets:** Locate in the Northwest or Southeast.
10. **Guard Room:** Best positions are the Northwest or Southeast.
11. **Parking:** Provide parking at Northwest or Northeast. Only light vehicles (scooters, cycles) are permitted in the Northeast.
12. **Underground Water Features:** Water pumps, bore-wells, and underground water tanks are best in the North-East.
13. **Overhead Tanks:** Erect at the West. Avoid the Northeast for overhead water tanks.
14. **Raw Material Storage:** Store all raw materials in the South, West, or South-West.

10 Vastu Do's for Factories

1. Prioritize proper plot size and slope.
2. Place the factory building in the West, South, or Southwest of the compound for profit.
3. Position main gates on the East or North wall.
4. Locate the administrative office in the North or East.
5. Store raw materials in the East or Southeast, and finished goods in the North, West, or Northwest.
6. Place a temple in the Northeast.
7. Situate the maintenance shed in the South or Southwest.
8. Put heating instruments in the Southeast.
9. Place toilets in the South of Southwest (SSW) or West of Northwest (WNW).



Chapter 11

The Importance of Vastu in Hotel Design

Good hotel infrastructure, guided by Vastu, is vital for attracting visitors and ensuring profitability. Vastu principles directly influence guest arrival and satisfaction through proper hotel placement and room directions. Incorrect construction can significantly hinder guest numbers and profits. Before building, a Vastu expert should assess the site, location, geography, soil, and directions. For existing hotels, remedies can nullify negative directional effects. Ultimately, applying Vastu Shastra leads to happier customers and employees, who become brand ambassadors, crucial for flourishing in the hospitality business.



Hotel Vastu: Designing for Success and Profit

Vastu Shastra plays a vital role in attracting guests and ensuring profitability for hotels. Proper site selection, layout, and room placement are directly linked to success and customer satisfaction.

Hotel Location and Plot

The ideal hotel location allows all sides to face a road; if not, at least the North and East sides should. The land should slope towards the North-East, and the hotel design should keep the North and East sides open. For the plot shape, opt for rectangular, square, circular, octagonal, or hexagonal for maximum profit.

Entrance

The hotel entrance is paramount for a welcoming first impression. It must be easy to find, accessible, and free of obstacles. Enhancing it with warm flowers, beautiful plants, exotic fountains, and a smiling doorkeeper leaves a lasting positive impact.

Hotel Flooring and Kitchen

The ground floor is most appropriate for the reception hall and a small cafeteria. While rooms can be on the ground floor, reception and kitchen are essential. The main kitchen on the ground floor should be in the South-East direction for success and health, ensuring adequate lighting, ventilation, and space. Additional kitchens on other floors should also follow this placement.

Room and Electrical Item Placement

Conference halls can be on the first floor. Guest rooms, including deluxe rooms and suites, should ideally be positioned in the South-West direction. Beds within these rooms should face South or West, ensuring guests' heads are towards the South or East when sleeping. Balconies on the Northern and Eastern sides can bring good luck. For electrical items, ACs are good in the South-East, while hair dryers and wash basins can be on the North, East, or Northeast sides.

Fountains and Water Bodies

To attract tourists, decorative water features like swimming pools and fountains should be placed in the North, East, or Northeast directions. Ensure these areas are large, open, and spacious to avoid chaos.

Hotel Colours

Use warm colours like orange, yellow, cream, brown, and tones of blue for interiors and accessories to create a vibrant, nourishing, and enjoyable atmosphere. Balance colours according to Vastu for different directions. Avoid cool shades like grey and green, as they can reduce customer turnout.

Bathroom Placement

For both private and external use, bathrooms and toilets are best constructed in the North-West or West directions. These directions help prevent negativity from entering the hotel and are considered auspicious.

Vastu Tips for Hotels: Attracting Prosperity

For a successful hotel, ensure a large area with ample open space, especially in the North and East, for positive energy flow. The main entrance, ideally in the North or East, should be appealing, with a welcoming doorman.

In the dining area, arrange square or rectangular tables according to the magnetic axis for comfort. The kitchen must be on the ground floor, in the South-East, for high-quality food. Favorable colors include yellow, cream, orange, and brown, while grey or green should be avoided.

Place electrical equipment in the South-East. Guest rooms should be in the South-West, with beds facing South or West. Toilets belong in the West or North-West. The swimming pool is best in the North-East. Finally, ensure the hotel plot is regular (square or rectangular) for increased profit and customer satisfaction.

The Power of Vastu in Hotels

Vastu for hotels helps owners achieve significant profits and enhances customer satisfaction. Guests unknowingly benefit from its invisible influence, enjoying warm, comfortable stays that encourage their return. This ancient architectural science ensures owners, staff, and customers leave content. Hoteliers are blessed with these Vastu tips, offering a cost-effective secret to success. Remember, the hotel's location and its interior/exterior Vastu compliance are paramount for a relaxing stay and delicious food.

Chapter 12

The Importance of Vastu in Hospital Design

Hospitals, places of hope and healing, can significantly impact patient recovery. A hospital designed according to Vastu Shastra principles creates a positive, comforting environment, aiding faster recovery. Conversely, poor Vastu can negate the efforts of even the most skilled medical staff due to its negative influence.

Vastu-compliant hospitals reduce negative energy, offering peace and good vibes to patients and visitors through invisible, balancing forces. Therefore, adhering to Vastu tips during hospital construction is crucial. It acts as a powerful channel to facilitate healing and ensures that patients leave with a sense of well-being, enhancing the hospital's overall effectiveness and reputation.

Vastu Guidelines for Hospital Planning and Design

For optimal hospital functionality and patient well-being, Vastu Shastra provides specific placement guidelines:

Entrance & Facilities: The hospital entrance should be in the East or North, accompanied by plants for fresh air. Drinking water coolers belong in the Northeast, kept clean with disposable glasses.

Reception: If the hospital entrance is in the Northeast or North, the reception should be in the Northeast zone, with low flooring for beneficial management.

Consultation Room: Doctors should sit in the West, South, or Southwest zone, facing the patient.

Operation Theatre (OT): Construct the OT on the West side. Keep equipment and operational machines in the Southeast. Patients’ heads should rest on the South side when entering.

Ventilation: Proper ventilation is crucial. Patient room ventilation should be in the Northeast to allow sunlight, aiding recovery.

Storeroom: Locate the storeroom for medical apparatus and surgical equipment in the West, South, or South-West. It should be built at a higher level than the main building’s flooring.

Emergency Rooms: The Southwest is the best location for emergency rooms, promoting faster healing and recovery.

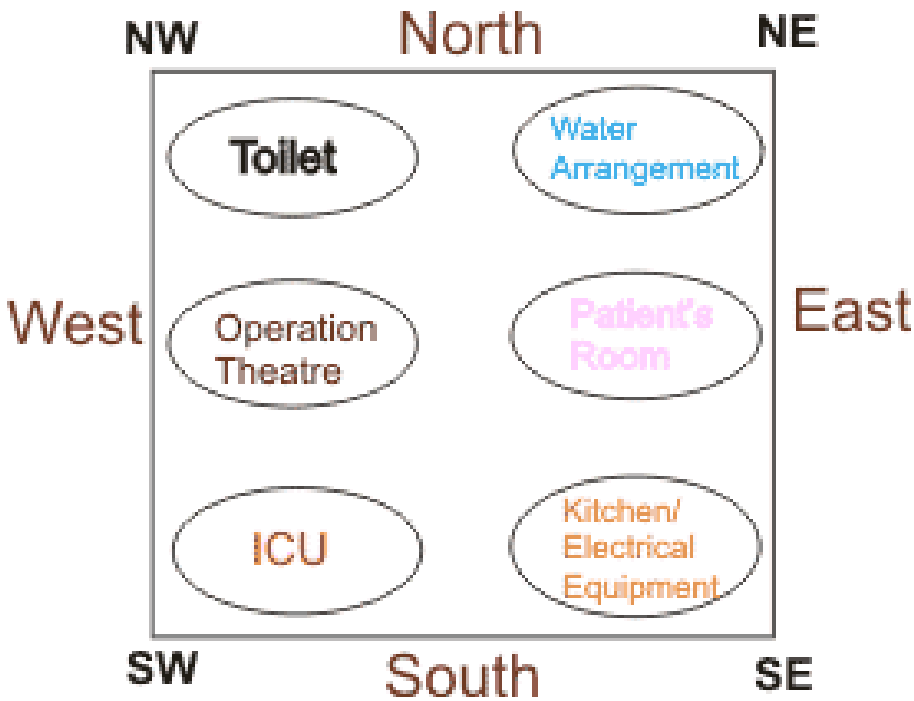

Vastu Tips for Hospitals

For optimal healing environments, Vastu recommends:

- Operation theatres in the West.
- Patient rooms should have ample Eastern ventilation.
- Storerooms should be elevated, with equipment in the Southwest or West.
- ICU and recovery rooms in the Southwest for quick healing.
- Water arrangements in the Northeast.
- Toilets in the Northwest or West.
- Kitchens in the Southeast.
- Recovery room beds on East or South walls; camouflage beams.
- Resting rooms/nurse quarters in Northwest or Southeast.
- Heavy electrical equipment in the Southeast.
- Medical books in South or West shelves.
- A garden is beneficial for fresh air.
- MRI and X-ray in the Southeast.
- Waiting rooms should be light beige/peach; reception in light crimson/purple, avoiding dark blue, black, or grey.



Chapter 13

Vastu for Shops, Showrooms, and Offices

Vastu Shastra offers crucial guidelines for shops, showrooms, and offices to attract positivity, prosperity, and ensure business success.

Main Entrance

The main entrance should ideally face East or North for maximum positivity and prosperity, though South and West-facing entrances can also work. Crucially, the entrance must always be neat, clean, and free from clutter or obstacles like decorative trees or statues, as it's the welcoming point for customers. Avoid placing your shop directly facing a drain or having stagnant water/slopes at the entrance, as these lead to financial loss and are considered inauspicious.

Sign Boards or Banners

The colors of signboards and banners must synchronize with the direction they face. For instance, a Northwest entrance benefits from white or grey signboards, while a North entrance prefers shades of blue, black, or white. Using misaligned colors, like yellow for an East-facing shop, can deter customers, proving critical to business success or failure.

Shape of Shop or Showroom

The shape of your shop or showroom significantly impacts your business. Vastu highly recommends rectangular or square shapes as the most ideal choices, promoting good decision-making and business success. Avoid triangular or irregularly shaped premises, as they can

cause mental stress and irregular income. Additionally, ensure the front of your shop is wider than its back for better productivity, as per Vastu Shastra.

Shop/Showroom Counter

The main counter should be square, rectangular, or angular. Avoid circular counters, as they can lead to financial losses. Placing the counter in the Southeast or Southwest direction is believed to bring business prosperity. Maintaining a neat, clean, and spacious counter further fosters profits.

Cash Counter

The cash counter should be placed in the North direction, considered highly auspicious for business as it's the abode of Lord Kubera, the God of Prosperity. It's crucial to never keep the cash counter empty. If a locker room exists, it should be in the Southwest direction, opening towards the North. For day-to-day cash or billing, the Southeast direction is ideal, as it's ruled by Lord Agni (fire), symbolizing cash flow. Placing the billing counter here is said to keep the cash register active.

Heavy Furniture and Showcases

The most suitable direction for showcases and heavy furniture is the Southwest, which is beneficial for business prosperity. Conversely, placing heavy furniture or showcases in the Northeast direction can lead to business losses.

Display of Products on Mannequins

For shops displaying products on mannequins (e.g., clothes, jewelry), placing them in the correct Vastu zone is crucial to attract customers effectively. (The provided text doesn't specify the ideal zone for mannequins, but emphasizes the importance of their placement.)



For attracting customers and selling products quickly, place mannequins and even unsold inventory in the North-West and North of North-West zones. These areas possess energies that draw attention, often resulting in rapid sales, even for long-stagnant stock.

Placement of Mirrors in Shop

Mirrors are vital in shop Vastu, doubling the energy of their placement zone. They symbolize the water element, so ideally place them in North, North-East, or West zones. Avoid mirrors in already extended areas to prevent energy imbalance. Crucially, never place mirrors in fire zones (South and South-East), as this creates conflict and can be detrimental to business.

Important Vastu Tips for Shops and Showrooms

For enhanced prosperity and customer flow in shops and showrooms, consider these Vastu guidelines:

1. Cloth shops ideally face North to attract and retain customers.
2. Place God photos or a Pooja room in the West for higher profits and gains.

3. A stationery shop facing West is best for increased profits and gains.
4. The cash counter should be in the Southeast for regular cash flow and higher sales.
5. A furniture shop facing South gains fame, recognition, and loyal customers.
6. Place computers, televisions, and electronic equipment in the Southeast corner.
7. Keep a temple in the Northeast Zone of the shop.
8. Keep a copper vessel filled with Ganga Jal.
9. Use the South, West, and Southwest areas for storage.
10. Ensure main and other doors do not make noise.
11. Utilize the Northwest direction for sales promotion techniques like display boards and announcements.
12. The shop owner should face East or North while sitting, avoiding South or West.
13. Avoid placing idols of Goddess Lakshmi and Lord Ganesha to the right of the Northeast part. Display auspicious Swastik signs and write "shubh-laabh" and "riddhi-siddhi" on a wall.
14. Always offer prayers, light a diya, and burn incense sticks after opening in the morning to revive positive energies.

Vastu for office

Direction of office building as per Vastu

For office buildings, Vastu principles are crucial for prosperity. The East is suitable for service industries, while the North (ruled by Kubera, God of Wealth) is ideal for profit-making businesses. The North, Northeast, and Northwest directions can also be beneficial depending on the business type. Additionally, when choosing an office location, ensure the property is surrounded by running roads for enhanced positive flow.

Office Vastu: Direction of different rooms

Location	Direction
Reception	Northeast
Entrance	East or North
Owner's room	Southwest
Staff	Northwest
Accounts department	Southeast
Conference rooms	Northwest
Marketing department	Northwest
Office Temple	Northeast
Cashier's office	North
Pantry	Southeast
Locker	Southwest
Water tank	Southwest or West
Staircase	West, South, Southwest
Toilets	ESE, SSW and WNW
Almirahs and racks	Southwest

Office Vastu: Strategic Seating, Layout, and Decor

Implementing Vastu Shastra principles in office planning optimizes energy flow, promoting productivity, financial gains, and a harmonious work environment.

Office Vastu: Sitting Position

Department-wise seating arrangement:

- Entrepreneurs should face North, East, or North-East for growth and new beginnings.
- Marketing or sales personnel should face North-East for proactiveness, with their seating in the Northwest.

- Account department officials should sit in the Southeast corner and face North-East.

Seating arrangement for managers and owners:

- Leadership roles (managers, directors, executives) should have cabins in the West and face North-East.
- Business owners should face East or North. Ensure a solid wall (not a wooden divider or curtain) is behind their seat.
- Managers, directors, and executives can also sit in the Southwest, South, or West corner of the office for better decision-making.

Employee seating arrangement:

- Employees should face North or East for improved productivity, and never face South.
- Avoid sitting directly under a light beam; if unavoidable, cover it with a wooden board.

Office Entrance

The office entrance should be in the North, North-East, or North-West directions. These are considered auspicious, bringing positivity and accelerating financial profits, as the North is ruled by the lord of wealth.

Create Positive Energy

- Maintain a clean and clutter-free space, locking away documents and stationery when not in use.
- Avoid sleeping at your desk, as it generates negative energies.
- Ensure your back does not face a door when sitting in a cabin to foster trust and awareness.
- Hang a mountain scenery picture behind your seat and keep a turquoise pyramid on your desk for support and communication.

Office Decor and Interiors

- To promote good financial health, place a mirror or Kuber Yantra in the North direction or on the northern wall.
- Avoid piling finished goods in the North-East, especially in front of desks. Instead, place them in the North-West for smooth clearance of unsold stock.
- Place your safe for financial documents in the Southwest corner, with its opening facing the North-East for prosperity.
- A water fountain in the North can promote career growth, reduce stress, and signify wealth flow. However, avoid fountains that flow outward from the entrance.

Office Electrical Equipment and Machines

- Electrical equipment and related items, including generators, electric meters, and transformers, should be placed in the South-East direction of the office building. This applies to pantry and kitchen appliances as well.
- Weighing machines should be kept in the North-West or East.
- Place printer scanners, servers, Wi-Fi routers, and camera monitors in the South-East zone.

Office Vastu: Lighting, Reception, and Pooja Room

Office Lighting: Proper lighting is essential for an energetic office. Maximize natural light as it's linked to positive vibes. For career success, ensure bright lights in the south zone. Avoid glare on computer screens and excessive light at individual workstations. Overall illumination should be soothing. The main entrance and reception should be well-lit with attractive fixtures to invite good energy.

Reception at the Workplace: Build the reception in the Northeast or East direction. The receptionist should sit facing North or East. Place the company logo or profile on the southern wall. The reception table

should be positioned diagonally to the front door. Enhance the area with French lavender, green jade flowers, or a four-leaf clover plant.

Office Mandir or Pooja Room: To invite financial growth, consider designing a pooja room in the Northeast or North corner. Adorn the mandir with idols, flowers, lights, and incense sticks. Avoid

Pantry/Canteen Area

Construct the pantry in the Southeast direction. It should never be in the North. Walls can be painted light blue or green, and plants can be kept there to foster positive energy.

Washrooms

Washrooms are sources of negative energy, making correct placement crucial. They should be in the West or North-West direction. Crucially, avoid locating washrooms in the East, North-East, or South-East.

Staircase

Staircases are best constructed in the South or South-West direction. Avoid spiral staircases, as they are considered imbalanced and can disrupt positive energy. Office staircases should be painted in light colors, not black or red. A staircase should never be in the center of the office, as this can lead to financial drain. Aim for an odd number of steps, and plants can be placed on the corners of each step.

Elevators/Lifts

Install elevators in the North or East directions. Avoid North-East and South-West at all costs. Do not install lifts directly in front of the main entrance, as this can flush out positive energy. Also, avoid mirrors on the lifts.

Office Desk, Chairs, and Cabin

- Place a mountain scenery picture in your cabin, behind the chair, for support.
- A turquoise pyramid on the desk can foster better relations with employees and peers.
- Keep your desk clean and clutter-free, ensuring unimportant documents and papers are locked away.
- Throw away broken stationery, as it impedes financial prosperity.

Wall Colors for the Office

Use bright colors for walls and decor to spread positivity and reflect light.

- **Green:** Use different shades for professional relationships, especially on the south-western wall to promote harmony.
- **White, Cream, Yellow:** Suitable for walls and corners in the Southeast, East, North-East, and North-West.
- **Red and Pink:** Can be used on southern walls if desired, though less common in office interiors.

Plants in the Office

Plants are excellent Vastu items, bringing good luck and freshness. Suitable plants for an air-conditioned office include:

- | | |
|----------------------|-------------------------|
| • Basil plant | • Cactus |
| • Money plant | • Lemon balm |
| • Lucky bamboo plant | • Jade plants (on desk) |
| • Lotus plant | • Areca palm plants |
| • Lily plant | • Dracaena plants |
| • Snake plant | |

Conference/Meeting Rooms

The best direction for a conference or meeting room is the North-West. This zone is also recommended for marketing and sales staff due to its motivational energy, and can also serve as a waiting room.

Comprehensive Office Vastu Guide: Furniture, Layout, and Remedies

Implementing Vastu principles in office design and setup fosters prosperity, positive energy, and improved productivity. From furniture choices to specific area placements and remedies for defects, aligning with Vastu creates a harmonious and successful workspace.

Vastu Tips for Choosing Office Furniture

- For north-facing workstations, keep files, documents, and electronics on the left side of the table. In a home office, the table is ideally in the southwest corner.
- East-facing workstations should have storage on the right-hand side.
- Never eat food at your desk as it disrespects work.
- Steel furniture is preferred for offices. If using wooden furniture, ensure rounded edges and use light-colored polish.
- Office chairs should be comfortable, spacious, offer good arm/lumbar support, and have a high back. A red touch on the chair can aid promotion, and white chairs or cushions are generally beneficial. Avoid iron chairs, and never use upholstered chairs with discolored/faded fabric or broken chairs; repair or replace them.

Shape of Office Desk

- Workstations or desks must not be L-shaped or any irregular shape, as this can cause confusion and delays.
- Business owners/entrepreneurs should have rectangular or square-shaped desks made of superior wood. Avoid glass-top or metal tables, as they are not considered lucky for growing businesses.

Office Vastu: Placement of Office Files in the Shelf

- **Southwest:** Store files related to purchase, estate, income tax, raw materials, stores, and personal files.
- **Northwest:** Keep files for sales, finished goods, pending bill receivables, litigation, and import/export. Share files can be in the northwest corner of the north wall.
- **Southeast:** Accounts files should be stored in this direction.

Vastu Tips for Office Decor Items

Certain decorative items can bring good luck and prosperity:

- Buddha statue at the entrance.
- Fish aquariums.
- Plants and flowers.
- Paintings like the auspicious seven running horses.

Vastu Tips for Office Gym

If your office has a gym, follow these tips:

- Place heavy gym equipment in the South-West, West, North-West, or South-East corner.
- Keep light equipment in the North. This direction is also suitable for mat exercises, which should be done facing East.
- Install mirrors on the North or East walls, avoiding West, South, or South-West.
- Do not keep televisions or distracting devices to maintain a peaceful environment and keep away negative energies.

Vastu Tips for Selecting Plots for Office

Shermukhi plots (broader at the front, narrower at the back) are suitable for commercial buildings. Choose a plot closer to highly operational roads.

Vastu Tips for Basement Office

An office basement should be constructed in the East or North direction, with more open space on these sides. Lofts and mezzanine floors should be towards the South, West, or South-West.

Vastu Tips for Office Parking

Vehicles should be parked in the specified area towards the North-West of the office building. The North-East should be free from parking zones.

Vastu Tips for Office Lawn

- Develop small lawns without trees in the North-East, North, and East directions.
- Design lawns with big trees on the South and West side.

Vastu Tips for Guardroom and Staff Quarters

- The ideal position for the guardroom is the Northwest direction.
- The Northwest corner is also ideal for staff quarters, with the Southeast as an alternative.

Vastu for Boss' Cabin

- The boss's cabin should be in the West or South-West zone.
- Top managers should face North or East while sitting.
- Ensure a solid wall (no religious pictures) behind the manager's chair.
- The table should be made of wood.
- The cabin door should be in the North-East corner.
- The office or cabin shape should be square or rectangular.

Common Office Vastu Defects and Their Remedies

- Extended Corners (North-West, South-East, South-West): Place aromatic plants in the North-West window, or use six-pipe wind chimes. The extended area can also serve as a storeroom.

- Missing South-West Corner: Place a lead metal Helix on the wall, or a lead pyramid for greater impact.
- Pantry/Kitchen Remedies: If the stove and sink are too close, place a copper swastika behind the stove and a Shriparni wood pyramid near the sink. If a pantry or toilet is in the center, keep Vastu salt in a wooden bowl and replace it weekly.

More Vastu Tips for Office

- Place a bright painting in the office's East direction to eliminate negativity and boost productivity.
- If the floor slopes towards South-East or West, place a lead metal or copper pyramid on the sloping side. For South-East slopes, three triangular coral stones can also be used.
- The central part of the office building must be kept empty.



Chapter 14

Vastu for Schools, Colleges, and Universities

Educational institutions are vital for student development, and constructing them according to Vastu principles can significantly enhance student success and well-being.

Soil Type: Before construction, test the land. Yellow or loamy/mixed soil is considered most suitable. The land should be defect-free, with a pure and calm atmosphere, as this impacts students' all-round development.

Plot Type: The plot for an educational institution should be large, ideally rectangular or square.

Main Gate Direction: The main gate is crucial. East, North, West, and South directions are considered best. An East or North-facing entrance is particularly beneficial, as students in such schools tend to be more qualified and intelligent, achieving commendable results. The main door must always be clean, with a height twice its width. There should be no obstacles like electric poles or large trees in front of the main entrance.

School Building Direction and Entrance

The main school building should be towards the Southwest, with its height taller than the Northeast side. Similarly, the Southwest wall should be higher than the Northeast. The school entrance should ideally be in the North or East direction, as this is considered auspicious, attracts students, and prevents clutter.

Colors for School/College

For study rooms, white, light yellow, light green, and cream are best. Yellow represents the brain (Guru), and green (Mercury) symbolizes learning. The main building's exterior colors should be Maroon, light yellow, light green, and cream.

Slope of Land and Roof

The slope of the entire land and roof should be towards the East or North. This prevents unnecessary problems and fosters the all-round development of students and teachers.

Location of Administrative Block

The administrative block, where financial and administrative work occurs, should be in the East or North direction to ensure proper financial management.

Avoid Using Beams

It's advisable to avoid using beams in student areas, as they can exert pressure on children's brains and eyes. Students should never sit directly under a beam.

Water System

Water arrangements like fountains, swimming pools, and underground tanks should be in the North, East, or North-East direction. Drinking water facilities should be towards the East or North of the main building. The overhead water tank should be on the South-West side of the building.

Electrical Systems

All power systems (generator, electric meter, main switches, fuses) should be in the South-East. Proper placement of fire extinguishers should also be in the South-East.

Canteen and Kitchen

The kitchen and canteen should be in the South-East direction, with

serving areas towards the East. These directions promote happiness, peace, and benefit.

Toilet Room

School toilets should be in the South, West, or North-West direction of the plot. Proper ventilation is essential. Students should face South or West while using the toilet.

Reception Counter

The reception counter should be in the North, East, or North-East of the main building. Visitors should enter from the East or North. The receptionist's face should be towards the East or North when communicating with visitors.

Principal's Room

The principal's room should be towards the South-West of the main building for effective control over tasks and employees. The principal should sit facing East, North, or North-East. There should be no door or window behind the principal's chair. Prizes and titles should be kept in the South direction of the office.

Study Room (Classrooms)

Classrooms should be in the East, West, and North directions. Students should sit facing East or North. The blackboard should be on the East or North wall. Classrooms need proper ventilation and should ideally have two gates. Display educational quotes and images of ideal figures.

Staff Room

The staff or teacher room should be towards the North-West of the main building, well-furnished and air-conditioned to ensure energetic teaching.

Library Room

The library should be on the North side of the main building. Students should sit facing East or North while studying. Book collections should

be kept on the West and South walls. The Head Librarian's chair should be in the South-West of the library room.

Laboratory Room

The laboratory should be constructed towards the South-East of the main building. Students should face East or North while working, and the head of the laboratory should face North when explaining.

Auditorium

The auditorium should be on the Northwest or West side of the school. The stage should be in the West of the auditorium, and music arrangements can be towards the North-West.

Parking Place

Parking for vehicles is suitable in the North-West or South-East direction. Vehicles should be parked properly.

School Prayer Room

The prayer hall should be in the North-East direction to improve children's concentration.

Classroom Location and Ventilation

Classrooms should be constructed in the North or East direction for a good atmosphere. Seating should allow students to face North or East. Proper ventilation is crucial; windows should be in the East or North direction. Exhaust fans can be installed if needed, and windows should remain open during classes for sunlight, air, and positive energy.

Meeting Rooms

The meeting room should be in the North direction, with its door in the East direction. Furniture should be arranged for easy movement.

Cashier Room or Counter

The cashier room or counter for money management should be in the North or East direction.

Conclusion

Schools, or “Vidyalayas,” are temples of knowledge where children gain wisdom and life skills. As their second home, schools transform young minds into efficient, responsible citizens, always eager to learn and grow.



Chapter 15

Plants and Trees as per Vastu: Enhancing Your Environment

Plants and trees hold a special place in Vastu Shastra, not only for their aesthetic appeal and calming presence but also for their profound impact on our physical and emotional well-being. Ancient texts like Garun Puran and Rup Mandal emphasize their significance. Vastu offers guidelines on planting specific trees and plants to foster an easy and prosperous life.



Vastu for Garden Trees and Plants

When designing a house compound, particularly with front and back gardens, Vastu provides valuable insights on planting auspicious trees:

Peepal Tree (Aswatha tree): Known for its high oxygen production, especially due to its dense foliage. While it's prohibited from being cut, it's not suitable near a house due to its expansive root system that can damage foundations.

Neem Tree: This tree is highly valued for its medicinal properties. Its extracts are used in pesticides, twigs for brushing teeth, and neem oil for physiotherapy. Symbolizing the acceptance of life's varied experiences, it's considered a good tree for a house garden.

Mango Tree: Most parts of the mango tree possess medicinal value. Its leaves are used as pesticides and for puja, and its twigs for dental hygiene. Mango wood is considered auspicious for cremation. The fruit is versatile, used in pickles and as a vegetable. With a lifespan of 400-500 years, it's a very useful addition to your garden.

Jack-fruit Tree: Like the mango, the jack-fruit tree yields abundant, tasty seasonal fruit. Its juicy kernels are used in sweets and chips, and its nutritious seeds are cooked as a vegetable. The tree's beautiful yellow wood is used for furniture and building components, and its leaves are auspicious for puja. This makes it a useful tree to plant in your garden.

Banana Tree: Banana saplings symbolize prosperity and wealth and are used for decoration during festivals. Almost every part of the plant has economic or medicinal value. The fruit is an excellent source of instant energy and potassium. Raw bananas are cooked as vegetables, and the skin is used in dyeing. Concoctions from its roots, stem, flowers, and leaves treat various illnesses, making it a must-have in your garden.

Coconut Tree: Every part of the coconut tree is useful, from its tender water (a healthy drink) to its flesh (used in cooking). Coconut oil is used for cooking and hair. Coir, a byproduct, is used for mats and carpets, and its leaves for roofing. Due to its extensive utility, it's considered a sacred tree and a must for your garden.

Sandalwood Tree: Highly expensive, sandalwood is prized for exquisite handicrafts and its fragrant oil. Sandalwood paste provides a cooling

effect when applied to the forehead, and the wood is used to make incense sticks.

Zones Effects

Strategic plant placement in your home's Vastu zones can enhance positive energy and address specific needs:

- **North:** Ideal for Money Plant, Bamboo Plant, Crassula Plant, Aloe vera Plant, and Awala plant to boost financial opportunities and remove negativity. Flowers like jasmine, sandalwood, lily, and Rajnigandha also thrive here.
- **North-East:** The Tulsi plant is highly recommended here or in the East, and lighting a lamp nearby in the evening is beneficial. Smaller shrubs like ashwagandha and awala can also be planted.
- **North-West:** A Neem plant is perfect here, strengthening planetary influences (Shani, Rahu, Ketu) and family relationships.
- **West, South-West & South:** Tall trees such as Coconut, Mango, Bael, Ashoka, and Jackfruit can be planted in these zones. Ensure they aren't too close to the building to avoid blocking sunlight, especially between 9 AM and 3 PM, to prevent their shadow from falling on the house.

Plants/Trees to Avoid Near the House: Steer clear of large trees like Peepal and Cactus too close to the house, as their roots can damage foundations. Also, avoid trees that attract insects, worms, honey bees, owls, or serpents.

Chapter 16

45 Devtas of Vastu

How Energy Fields Develop During Construction

Whenever any enclosed space, like a house, office, or even a simple image, is created, energy fields form within it. These fields, perceptible through practices like meditation, influence emotions and can be consciously designed, as seen in stationery or company logos.

While energy fields naturally exist on any land, their quality can be significantly improved. In Indian Vastu Shastra, this “alchemy of space” is achieved through astrological calculations (Jyotish). Texts like Vishwakarma Prakash detail how to select an auspicious time for laying a foundation (known as Shilanyas in India). This timing, considering planetary positions, facilitates the formation of optimal energy fields and determines the building’s energetic lifespan.

This ancient practice is crucial; neglecting these energy fields can lead to adverse outcomes. For example, some beautiful, well-located buildings in Dubai remain deserted because their natural energy fields have dissipated, highlighting the profound impact of Vastu on a structure’s vitality and purpose.

Creating the Creator (Brahma) in Vastu

During construction, after the foundation and plinth are established, a powerful golden-white energy field emerges at the plot’s center. Vedic seers, through deep meditation, perceived this field, recognizing its potential to manifest all life forms and processes. This central energy,

termed Param Tattva, Param Purush, or Brahma in scriptures, is the very first to develop.

The strength of this “Brahma” energy field varies—it can be powerful, moderate, weak, or even non-existent. If it fails to develop, construction may cease, often due to the land’s inherent qualities. This central energy is considered responsible for the evolution of the universe, hence the concept of “Brahmand” (Brahma’s egg) and the universe originating from a golden egg.

Development of 4 Devtas in Vastu: Aryama, Viviswan, Mitra, and Bhudhar

As a building’s construction progresses and walls reach 5-8 feet, the central golden energy field expands, evolving into four distinct colored energy fields, much like a blossoming flower or ripples in water.

These fields manifest in specific directions:

- **East:** Develops into a dark blue energy field, known as Aryama, the connector.
- **South:** Becomes a white energy field, termed Viviswan or Viviswat, the controller of change.
- **West:** Appears as a silvery-white field, identified as Mitra, the motivator.
- **North:** Transforms into a rust-red (burnt copper) energy field, called Bhudhar, representing manifestation power.

Vedic seers experienced these energy fields not only during construction but also in natural processes like a flower’s blooming or a child’s birth, where similar energetic expansions occur. They observed these four directional fields as the “four faces of Brahma” (Chaturdik), recognizing directions as crucial reference points for the expansion of these divine energies from the center. Each of these four “Devtas” (energy fields) possesses unique qualities and attributes, forming the basis of the Vastu Purush Mandala.

Bhudhar: The Manifestation Power (North) Located in the North as a coppery-red energy field, Bhudhar (meaning “the one who carries the power of Manifestation”) is responsible for bringing the universe and all existence into being. It’s the foundational force of manifestation.

Aryama: The Connector (East) The blue energy field in the East, Aryama, supports growth after manifestation and connects entities within the world. This power facilitates companionship and relationships, crucial for the continuation of evolutionary processes. In Vedic texts, Aryama is invoked for connectivity and finding a partner.

Viviswan: The Controller of Change (South) Found in the South as a white energy field, Viviswan (also Viviswat) is the initiator and controller of change. It drives the manifestation process by initiating and shining light on the necessary transformations.

Mitra: The Motivator (West) The silvery-white energy field in the West, Mitra, is the inspirational force that brings all these processes into action. Repeatedly invoked in the Atharvaveda, Mitra is seen as the power that binds and holds the world together, allowing the process of evolution and manifestation to move forward.

Walls

Origin of Eight Devtas and Asuras in Vastu

Vedic seers observed that as building construction progresses and walls are built (with roof casting remaining), energy fields emerge in the diagonal corners or zones: North-East, South-East, South-West, and North-West. This formation resembles a tortoise with extending legs.

Within each of these diagonal directions, two distinct energy fields develop. For instance, in the North-East, a silvery-white energy field appears. If you draw a line from North-East to South-West through the center, one field forms on the northern side of that line, and another on the eastern side.

These paired energy fields are named as follows:

- In the North-East: The field towards the North is called Aapaha, and its adjacent counterpart is Aapahavatsa.
- In the South-East: The Devtas Savita and Savitra are depicted.
- In the South-West: Indra and Jaya emerge.
- In the North-West: The Devta Rudra and the Asura Rajyakshama are present.

These specific energy formations are fundamental to understanding the subtle forces at play in a Vastu-compliant structure.

Aapaha - Healing Booster and Aapahavatsa - Carrier (North-East)

Aapaha – Healing Booster: Located in the North-East, Aapaha is associated with healing, immunity boosting, and overcoming fears and challenges. Atharvaveda identifies Aapaha as a deity of ailment control, bringing a driving force to humans and being the life (prana) of water streams. Meditating here is said to improve immunity and connect one to higher states of consciousness (Vigyanmaya and Anandmaya Kosha). An imbalance in this zone can destroy healing power.

Aapahavatsa – Carrier: Positioned on the eastern side of the North-East, Aapahavatsa is considered the son of Aapaha. He carries medicinal elements to diseased points in the body and transfers insights from the intuitive mind (Vigyanmaya Kosha) to the conscious mind (Manomaya Kosha). Essentially, if Aapaha brings ideas, Aapahavatsa carries them to practical application, making worship or meditation in this field beneficial.

Savita - Igniter and Savitra - Pusher (South-East)

Savita – Igniter: This copper-red energy field in the South-East is responsible for igniting, initiating, and stimulating action (karma). Often synonymous with Surya (Sun), Savita removes ominous symptoms, activates powers through cleansing or friction, fosters connections with

influential people, and provides support and money. It also bestows the power of meditation and offers solutions to problems, granting determination and willpower when balanced. The presence of Ganesh ji is very beneficial here.

Savitra – Pusher: Savitra, a white-colored energy field found with Savita, is considered a powerful entity, even a demon with vast resources, who governs desires and grants strength and nourishment. Vedas state that Savitra keeps the Earth intact in space and bestows the determination for steady meditation and the power to grant luxuries. The Gayatri Mantra originated from Savitra, who provides the strength to move forward in life through earned virtues. Shree Yantra is also beneficial in this zone.

Indra - Protector and Jaya - Winning Tool (South-West)

Indra – Protector (E4): This very dark brown-red (sometimes green) energy field in the South-West is primarily a protector and guardian of wealth. In Vedas, Indra is considered the primary deity for safeguarding money and also associated with the medicine of conception. Therefore, Vastu recommends the South-West for labor rooms, as Indra's powers are believed to stabilize pregnancy and grant strength and longevity. Atharvaveda supports its role in safe delivery and securing valuables. Balancing this zone, along with Varun and Varna, enhances powerful contacts, luxury, and financial gains. An office table here can lead to top positions. An Ashoka Pillar in a balanced zone provides government-related benefits. Conversely, a toilet here can lead to lack of recognition and social disrespect. Bedrooms here foster powerful connections, and living rooms are beneficial. Sleeping here can alter temperament and choices, leading to a desire to associate with the best in society. While orange color is positive here, black (representing Saturn) has shown negative effects. This zone influences family stability, basic growth, and thought processes.

Jaya – Winning Tool: The silvery-white energy field on the diagonal axis in the South-West is Jaya (sometimes Jayendra). Jaya is symbolic of

Indra's weapon (Vajra) and all infallible tools for victory. As construction progresses, this power develops into the ability to impart skill and expertise. Vastu recommends this direction for storing tools, books, and objects related to one's skills. In any field, one's skill is the "Jaya" that ensures victory. A Vastu-dosha here can impair one's ability to effectively use their skills. Jaya channels the thought processes of Indra into manifestation.

Rudra - Channeliser and Rajyakshama - Holder (North-West)

Rudra – Channeliser: Mentioned in Rig-Veda as cunning and a head of thieves, Rudra also possesses a unique method of treatment. It is the power that makes water streams flow on earth and maintains the flow of activities in life. Historically, this direction was used for storing food grains (new crop sustaining life). In modern contexts, it's recommended for keeping ready-to-sale goods (stock), as their consumption maintains industrial flow. Rudra signifies that which causes weeping, detoxification, and emotions. Later, in 'Shatpath-Brahman', Rudra is associated with Lord Shiva, possibly due to Shiva's role in making the Ganga flow. Rudra facilitates channelizing support, maintaining day-to-day activities without interruption, influences emotional balance, and fosters the flow of ideas, aiding in completing work with ease.

Rajyakshama - Holder (North-West) and the Dynamic of Prakriti & Purush

Rajyakshama – Holder: This red-colored energy field, co-existing with Rudra in the North-West, is an attendant of Rudra and the "Lord of all roots." Rajyakshama embodies the power that holds foundations together, strengthens them, and maintains stability, literally binding walls. It also has the ability to still the mind. If this zone's energy becomes wrathful, it can lead to extreme mental instability. Crucially, this energy temporarily ceases the Universal Mind, allowing the initiation of creation; without this cessation, new life and creation are not possible. Thus, Rajyakshama is the power that maintains this creative pause and holds the new structures within which life manifests, initiating the world's creation.

At this stage, the space, still open to the sky, divides energetically: the South-Eastern side acts as Prakriti (Female), and the North-Western side acts as Purush (Male). These are initially inactive elements taking their places for creation. However, once activities begin in the completed building, this alignment shifts: Prakriti moves to the Purush side, and Purush to the Prakriti side. This change becomes permanent once all roofs are cast and construction is complete, signifying the building's purpose. Symbolically, this state represents the Vastu Purush lying prostrate, with his right (Pingala/Surya) nadi on the South-Eastern side and his left (Ida/Chandra) nadi on the North-Western side. When imbalanced, support received may not last.

Roof

Origin of Sixteen Devtas and Asuras: The Vastu Purush Conception

Upon the casting of a building's roof, four additional energy fields manifest in each diagonal direction. This configuration gives rise to the conception of the Vastu Purush, visualized by Vedic seers as an embodied figure with a head in the North-East, elbows and knees in the South-East and North-West, and feet in the South-West. Different Devtas inhabit these energy fields.

Aditi - Peace, Diti - Vision, Shikhi - Yogi, Parjanya - Insights (North-East)

In the North-East (Ishaan Koan), when the first roof is cast, four specific energy fields develop: two golden-yellow, one red, and another golden-yellow.

Aditi (N7) - Peace: This golden-yellow energy field is also known as Vishwadevi. Atharvaveda describes it as the force that sustains the entire world, providing boundless peace, serenity, and security. Aditi helps maintain integrity and perfection, often termed "Mother Earth," bestowing the power of "milk mixed with honey." It's the power of self-connectivity.

Key Points:

- Offers the power to overcome all obstacles.
- Imbalance leads to restlessness, nervousness, fear of the unknown, and feeling directionless, causing overall life imbalance.
- Provides the platform for Diti, Shikhi, and Parjanya.
- Bestows the power to receive solutions from Universal Consciousness for difficult situations.
- Mother-like field.
- If extended, the person constantly seeks gurus for problems.

Diti (N8) - Vision (North-East)

Diti, a golden-yellow energy field adjacent to Aditi in the North-East, is considered the mother of demons in Vedas. It grants expressive capability, wider vision, and liberal thinking, allowing one to see life's real truth and nature's actual form. When balanced, it provides mental clarity, purpose, and enables achievement without blindly following traditions. Children born in such a building can innately say "no."

Key Points:

- Broad-mindedness, far-sightedness.
- Impacts at a very deep level, removes duality when balanced.
- Gives the power to say "NO."
- Imbalance leads to a confused mind, inability to visualize aspects, and difficulty making decisions; people may not follow traditions/rules.
- An entrance here can foster spirituality and female dominance in important roles.

Shikhi (E1) - Yogi (North-East)

Shikhi, the red energy field East of Diti in the North-East, signifies a "pointed flame" or a ray of light, symbolizing the power to project

thoughts and influence the world with ideas. This deep-rooted thought energy paves the way for new creations, products, and services – from airplanes to computers and space exploration. It is considered the “Third Eye of Shiva,” the power to conceive any idea.

Key Points:

- Power to conceive any idea.
- Heavy objects here cause imbalance.
- Can lead to eyesight issues.
- Office gate here can cause electricity-related problems.
- Entrance here brings fire, accidents, and losses.
- A kitchen here causes anger, frustration, and mental disturbance.
- A store here leads to a blocked mindset.
- A toilet can be associated with mental defects.
- Sitting here for long periods can cause disinterestedness in life.

Parjanya (E2) - Insights (North-East)

Parjanya, a golden-yellow energy field further East in the North-East, is associated with flora generation and considered the “husband of the Earth,” satiating it like rainwater to produce growth and fruits. Meditating here brings wisdom and insights from the Universal Mind to the intuitive mind (Vigyanmaya Kosha). It grants fertility in cows and women and is responsible for the development of psycho-medicines.

Key Points:

- Best place to meditate, gives insights.
- Suitable for flora and fauna.
- Can lead to more female births and affect females of the home more strongly, making them bolder and dominating.
- A toilet here can result in much effort with no returns and women’s fertility issues.

- A washing machine here can cause conception issues for females.
- A dustbin can cause cysts.
- A kitchen here leads to inadequate returns.
- A mother-child photo improves their relationship.
- Flower bouquets and fruit baskets bring good results and abundance.
- An entrance here can also lead to increased expenditure.

Bhrisha - Gravity (South-East)

Bhrisha (E7) is the yellow-colored energy field in the South-East, symbolizing gravity and the power to bring forth new things through friction or churning, similar to how butter is extracted from curd. This energy is essential for correct and timely execution of actions. If weak in a building, it can lead to either excessive overthinking, delaying outcomes, or hasty, unplanned execution, resulting in undesirable results. Vastu suggests activities involving churning here to optimally utilize its power.

- This field brings things out by rubbing.
- A weak Bhrisha can cause excessive thinking, disturbing results.
- You can balance this zone by placing a mixer-grinder here.
- A “cut” in this zone can hinder decision-making.
- While white color hasn’t shown negative effects here, blue color can lead to significant problems.
- This zone is associated with Kama Deva, the energy that creates desires.
- The presence of sewerage or metallic art/showpieces here gives unfavorable results.
- A sewing machine in this area can cause BP fluctuations and anxiety.
- If an elderly couple sleeps here, the wife might experience continuous illness.
- If your thinking or analysis isn’t clear, examine this field.

- A boss sitting here might become overly strict, potentially causing future issues.
- Placing a Kamdhenu here is considered beneficial.

Antariksh (Akash) - Inner Space (South-East)

Akash (E8), the blue-colored energy field next to Bhrisha in the South-East, represents inner space, the vital void between Earth and Heaven that sustains life. When people feel “suffocated” or lack “space,” they’re often referring to this Antariksh. This crucial space enables the mind’s evolution and provides the necessary physical and mental support for Bhrisha’s power to manifest. Just as a plant needs room to grow, or a car occupies space, a building needs this energetic allowance; without it, manifestation isn’t possible.

- This field represents the space between Earth and Heaven.
- It’s like the “oxygen” needed for anything to happen; manifestation is possible only through Akash.
- If things feel “stuck,” such as payments or marriage, check this zone for imbalance.
- A door in this zone can cause financial losses.
- Keeping objects here can lead to them being recognized and appreciated.
- A weak Antariksh zone increases the chances of theft.
- Placing a red bulb here is considered good.
- An imbalance can lead to aggression and body rashes.
- Copper is beneficial for balancing this zone.
- As a field associated with Venus, an imbalance here can affect females more than males.
- A “cut” in this field may result in the elder son being away from home and not integrated with the family.
- A store in this zone can adversely affect happy events in life.

Anil - Uplifter (South-East)

Anil (S1), the blue-colored energy field in the South-East, is the deity of air (Vayu). While Antariksh provides the space for manifestation, Anil is the power that elevates or lifts things within that space. It initiates processes and enables upward movement, like lifting a building or fire. Anil bestows the ability to vigorously move forward in life, even amidst difficulties.

- This field is linked to wind energy.
- If a project isn't starting, check this energy field.
- A door here can negatively affect the elder son.
- Disturbances in this energy may reduce semen count, impacting childbirth.
- Sleeping here might cause restlessness in females.
- The presence of yellow color here can indicate a severe cash crunch.

Pusha - Strength (South-East)

Pusha (S2) is the red-colored energy field in the South-East, signifying nourishment, strength, and promotion. Vedas mention Pusha alongside Indra for blocking enemies, and Vastu recommends this zone for keeping ghee and other nourishing items. Pusha also safeguards journeys and is invoked for recovering lost money. Alongside other deities, Pusha helps select a bridegroom. As the primary protector of buildings, Pusha imparts strength and nourishment to life.

- This zone is nourishing, like a mother.
- It's the best place to keep ghee.
- It safeguards everything, including money; check here if payments are blocked.
- Acts as fuel to continue endeavors.
- A red mat here can help recover blocked money.
- For unsatisfactory fetal growth, place a red mat and ghee here.

- Imbalance can cause family bonding issues.
- Family photos here strengthen family ties.
- Blue color indicates a weakened body.
- Imbalance can lead to children not being self-sufficient or individuals working under others.
- A toilet here can negatively affect a child's growth.
- Keeping a Fevicol tube or a Hanuman Ji photo can improve family bonding and strengthen this zone.

Bhringraj - Discriminator (South-West)

Bhringraj (S7) is the blue-colored energy field in the South-West, representing the power of discrimination and wisdom. It enables one to discern and retain what is essential while discarding the unnecessary, much like the body extracting nutrients from food and eliminating waste. When this power is weak in a building, it can lead to increased expenditure, unsuccessful efforts, and a person wasting time and energy on useless pursuits. Vastu Shastra considers this an ideal location for a toilet, as it facilitates a balanced and smooth disposal process at physical, energy, and mental levels.

- Imparts discriminatory power, helping decide what to keep or remove in life.
- Aids in controlling abortions and miscarriages.
- Provides the wisdom to assess things properly.
- A toilet in this zone is excellent.
- Placing a bed here can result in wasted efforts.
- If this zone is extended, it can lead to more female births in the family.
- It's advised to spend 20 minutes here to release useless thoughts and things.
- An entrance here can cause a total waste of efforts.

- If someone is indecisive (“what to do or not to do”), check this energy field.
- Spending too much time here can make the mind rigid.

Mrigah - Curiosity (South-West)

Mrigah (S8) is the golden-yellow energy field adjacent to Bhiringraj in the South-West. “Mri” signifies craving or seeking, highlighting Mrigah’s role in generating curiosity and a desire to search and investigate, which is fundamental to life. This Devta is described as being moved by a craving, similar to a deer seeking a smell originating from its own navel. In Vastu, Mrigah bestows the power to develop skills, cultivate a seeking nature, and gain detailed knowledge through practice. Historically, this area was used as a bedroom for common people to optimize this power, aiding those who worked with their hands to improve their craft.

- Generates curiosity.
- Imparts the ability to grasp the essence of things.
- Encourages continuous searching to satisfy curiosity.
- Helps decode the secret of skills.
- Enhances skills and proficiencies to optimal levels.
- This is a suitable place to keep a study table and tools.
- An eagle symbol here can provide foresight, detailing, and a broader vision.
- A toilet here diminishes learning and thinking capabilities.
- Fire in this zone can hamper the power to learn new things.

Pitra - Ancestor (South-West)

Pitra (W1) is the red-colored energy field in the South-West, representing ancestors. This field provides all the means for your happiness and sustenance, granting safety, happiness, and the capacity to donate. It’s invoked for the birth of male children and welcoming a new bride, fostering family love and bonding. The attributes of Nairitya Koan in Vastu relate directly to Pitra’s power.

- Responsible for childbirth and marriage.
- Promotes family bonding, love, and understanding.
- Imbalance leads to continuous life struggles and feelings of disturbance.
- A toilet here causes instability in life and everyday problems.
- Sleeping here can make a person overly critical and perfectionistic, potentially causing constant tension with family.
- A kitchen here leads to digestion issues, particularly for males.
- Sewerage causes serious health problems.
- Avoid keeping tools here; an Aloe Vera plant can cause piles.
- Placing a family photo with yellow light is highly beneficial for strengthening this zone.

Dauwarik - Door Keeper (South-West)

Dauwarik (W2) is the red-colored energy field found West of Pitra in the South-West. Possessing infinite knowledge (Agam Shastra), Dauwarik is referred to as the door keeper or filter. This Asura, despite being a demon, is a genius embodying heritage and traditional knowledge. Dauwarik's power helps individuals progress step-by-step in knowledge, filtering out unwanted thoughts and subjects. It decides what knowledge should be absorbed and enhances memory in the subconscious mind.

For children's excellent studies, Dauwarik's power must be balanced in a building. If weak, children may struggle to retain learned information and forget during exams. When balanced, Dauwarik bestows the power of discrimination, enabling a person to evaluate the benefits of expending time, attention, money, and energy, thereby increasing savings by controlling wasteful expenditure at both physical and mental levels.

- Decides what enters and what is omitted from life, acting as a filter.
- Responsible for stepwise knowledge and the power of discretion/discrimination.

- If someone complains of “total wastage of efforts,” examine this zone along with Bhiringraj.
- Nandi remedy is considered best here.
- A weak zone can lead to insecure relationships.
- A piggy bank is associated with savings here.
- A bed here makes one mindful and cautious, improving understanding.
- A weak zone can cause inability to use or save money.
- Imbalances here can lead to wasting money on useless products.
- Helps students gauge what to study and its importance.

Shosha - Dryer (North-West)

In the North-West, a blue-colored energy field called Shosha (W7) develops. Shosha, considered a demon in Vedas, is the power that dries things up. As an attendant of Rudra (who causes weeping and water flow), Shosha completes the process of weeping (detoxification) by drying up tears, providing relief from depression or intense emotions. It helps one move past negative experiences.

- If this zone is imbalanced, residents may feel low due to negative experiences and mental breakdowns; balancing it aids self-support.
- Enhances the ability to communicate thoughts, share feelings, and clear one’s heart to feel light.
- Can be associated with thyroid problems.
- A “cut” in this zone can cause depression and inability to express emotions.
- A shoe-rack and dustbin can be kept here.

Papyakshma - Addictor (North-West)

Papyakshma (W8) is a yellow-colored energy field next to Shosha in the North-West, considered a demon. While it’s associated with diseases, alcoholism, guilt, and mental weakening, it also grants the capacity

for saving. From a yogic perspective, Papyakshma controls negative energies like accumulated guilt and miseries that cause blockages in life. Prolonged exposure to this energy field can foster a negative attitude, an obsession with finding others' mistakes, social disconnection, and a propensity for alcohol or drug abuse to combat loneliness. Vastu suggests a designated "weeping place" in this zone to balance its power, controlling the negative forces that weaken the mind.

- Causes disease, weak mind, and negative behavior.
- Residents may struggle to control their thoughts and speak negatively.
- An entrance here is considered detrimental and can lead to addiction.

Rogha - Weakener/Supporter (North-West)

Rogha (N1) is a red-colored energy field in the North-West. While it can weaken strength, it also acts as a supporter and destroyer of diseases, providing aid during tough times. Rogha's power is comparable to an inverter: it continuously consumes and stores energy, then immediately releases it when needed. In life, as we invest resources (money, time, relationships), a balanced Rogha ensures immediate access to money and support when required.

- Drains energies and can cause fever.
- When balanced, it destroys diseases and provides the ability to handle tough times.
- An entrance here can cause "death-like pain" or severe distress.
- If balanced, it makes a person energetic and supportive.
- A toilet here can result in a failure to receive support.
- An imbalanced zone can significantly disturb the mother of the family.
- Keeping grey stones or similar photos here provides stability.
- If a boss isn't supportive, placing one's photo with the boss here is suggested.

- Family photos are also recommended here.
- Brass elements are good here.
- An entrance here can metaphorically “shatter one’s reputation.”

Naga - Craving (North-West)

Naga (N2) is another red-colored energy field in the North-West, considered a serpentine demon (Sarp Asur) and the giver of emotional enjoyments. Naga grants the power to control sexual tendencies (Mooladhar-related) and derive pleasure from them, generating lust. Mythologically, Naga is Kaamdeva’s weapon, binding individuals with sexual desire. It’s also linked to Varun’s “Nagpash” power, used to bind. In Vedas, Naga is invoked as a weapon to bind enemies in lower human sensual activities, yet paradoxically, this demon is invoked as a Dev.

- Generates lust and desire.
- An entrance here can cause jealousy.
- Imbalance can attract people who are jealous.
- Products placed here will attract people.
- A mirror here can greatly increase materialistic desires.
- An ironing table or shoe-rack is not recommended here.
- If a dustbin is kept here, residents may be less liked by others and people may not want to associate with them.
- Placing a Lakshmi Ji Silver Murti here is excellent for financial gains.

These 45 energy fields, known by various names, develop throughout the Vastu Purush Mandal as construction progresses. After the first roof is cast, all remaining Devtas continue to take their places, leading to the building’s completion. The text concludes by indicating that the next discussion will delve into the attributes and significance of these sixteen Devtas in greater detail and their role in the world’s creation.

Completion of Structure

Origin of Sixteen Devtas and Asuras

Upon the completion of a building's civil structure, before services like electrical and plumbing are installed, sixteen new energy fields emerge. A transparent energy field forms in each cardinal direction (East, South, West, North), subsequently dividing into four distinct parts within each direction.

Jayant - Success, Mahendra - Administrator, Surya - Controller, Satya - Goodwill (East)

In the East, this field divides into two golden-yellow parts, one burnt-red/coppery-red, and one silvery-white (pearl) part.

Jayant (E3) - Success: This golden-yellow energy field in the East is associated with victory and success in all endeavors. Jayant imparts a sense of triumph and refreshes both body and mind, infusing individuals with enthusiasm to execute new ideas, leading to success. When balanced, occupants remain focused on their goals without being bogged down by trifles, and the home's atmosphere remains cheerful, enhancing social contacts and growth.

- Ensures success in all undertakings and provides goals and enthusiasm for ideas.
- A sword placed here might make one critical and bitter in speech.
- A bedroom here can make a person street-smart.
- A toilet has negative effects on children, making them shy and unable to express themselves well.
- Black color or circles can sometimes have negative effects.
- Wine storage or a bookstore here can benefit social mingling.
- Plants are very good in this zone.
- It teaches "Sam Daam Danda Bheda" (strategic policies).
- An entrance here equips residents for success in the materialistic world, bringing money, profits, and success.

- Living rooms and dining areas are suitable here.
- Impacts the mind, helps with creative solutions, and imparts action and determination.

Mahendra - Administrator (East)

Mahendra (E4) is the next golden-yellow energy field in the East, considered a highly significant deity, after Aapaha and Agni. Primarily, Mahendra is the administrator deity for associating people and fostering the power of association. Originally Indra, he earned the title Mahendra after defeating the demon Vatra. His chariot, moving with the speed of mind, signifies his control over the five senses and his role as the deity of the mind. Mahendra bestows the administrative power to effectively manage and get work done within an organization. When balanced in a building, Mahendra's energy grants connections with high-ranking government officials and administrators, leading to abundance, wealth, and luxuries.

Surya - Controller (East)

Surya (E5), the next deity in the East, has a coppery-red energy field and is considered a primary deity in Rigveda. Symbolically representing the core controller or soul in any system, Surya destroys negative forces residing in darkness. Vedas also describe him as the eye of Varun and Agni, and the lord of eyes, bestowing farsightedness and observational power. In a Yogic sense, becoming an observer and establishing oneself in the soul grants the power of Surya, which runs the world. When Surya's power is balanced in a building, the occupants gain fame and recognition in society.

- Guardian Power and Controller of Systems.
- Increases farsightedness and observation power, leading to better control.
- Chief of the nine planets, depicted by a seven-horse chariot.
- Balances energy and strength of residents.
- A door here can cause short temperament and aggressive behavior.

- If a boss sits here, they might feel a lack of control over the work environment.
- Placing a poster or Murti of Lord Vishnu here is highly beneficial.
- A copper sun is advisable when the overall fire element is weak, even if the South zone is also weak. Brass sun is generally beneficial.
- A weak Surya field can make the men of the house very mellow and soft.
- A kitchen here can bring aggression.
- Orange color yields positive results.
- If this field is weak, things at home or office may lack systematic organization.
- Imbalances can be associated with a lack of sex drive in men.
- If the owner complains that “nobody listens to me,” check this field.
- Temple placement here has shown no negative effects.

Satya - Goodwill (East)

Satya (E6), the silvery-white energy field next to Surya in the East, is associated with goodwill and status. Though no “Satya” Dev is explicitly named in Vedic literature, a deity named “Satyen” is described as responsible for establishing authenticity, credibility, and reputation. Satya is considered a supporter of Surya, characterized by sharpness, emotional intensity, and an undeterred nature. When this energy field weakens in a building, residents may lose credibility, trustworthiness, and reputation. Satya grants the ability for proper thinking and analysis, forming the basis for successful task execution and maintaining a person’s goodwill and commitments in society.

- Creator of goodwill and credibility, with attributes close to Surya.
- Imparts the power of right thinking and encourages fulfilling commitments, especially marriage.
- Imbalance can lead to a person moving from one partner to another, and others failing to fulfill commitments towards them.

- A mirror here can be dangerous.
- Green plants are acceptable, but blue color has shown negative effects, causing people not to fulfill promises.

Vitatha - Pretension, Grihakshat - Ceasor, Varna - Order, Gandharva - Preserver (South)

After the East, the transparent energy field in the South segregates into four different colors.

Vithatha (S3) - Pretension: Starting from the South-East, the first energy field in the South becomes a transparent, highly shining silver color. In Vedic language, this is Vitatha, related to the unreal world, falsehood, and pretension. Vitatha embodies the mentality of showing off, projecting a false image, and living a masked life – literally “moving opposite (vi) to facts (tath).” Vastu Shastra emphasizes using even “bad” forces positively; positive pretension (e.g., affirming one’s inner capability) can yield positive results. Misusing Vitatha’s power, however, leads to disrepute if the pretension lacks depth and authenticity.

- Associated with pretension, untruth, and falsehood.
- If extended, family members may become self-important.
- When balanced, it fosters very good self-confidence.
- Imbalance leads to mere show-off and false commitments.
- A door here can encourage unethical means.
- People sleeping here may become very bossy.
- Toilets here can make people feel their capabilities are limited and create self-doubt.
- A door here can bring prosperity and abundance.
- Balanced, it provides self-confidence.

Grihakshat - Ceasor (South)

Grihakshat (S4) is the golden-yellow energy field next to Vitatha in the South. While not explicitly found as a named Devta in Vedas,

its meaning is derived from “Griha” (ceasing the mind) and “kshat” (supporter). Grihakshat is considered a deity of the building, embodying the power to control and bind the mind within boundaries. A building, as a “Griha,” defines the limits of your mind, and Grihakshat governs this control.

Furthermore, Grihakshat acts as a supporter by defining the boundaries or domain of your helpers, ensuring your consciousness extends effectively for specific tasks.

- Represents “Mann ka dayara” (mind’s boundaries) and aids self-control.
- Crucial for achieving success in desires.
- Imbalance can lead to forgetting responsibilities, casual attitudes, and a lack of peace.
- A door here is beneficial, leading residents to enjoy life.
- Blue color may cause court cases or misunderstandings, conflicts, commitment failures, and bad company.
- A large water body here can result in undisciplined students.
- Children sleeping here may exhibit better discipline and good behavior.
- If imbalanced, people may not listen to advice.

Chapter 17

Vastu Helix and its uses

The Vastu Metal Helix is a powerful remedy for balancing elemental defects and correcting corner flaws in a building. It's used to address issues like incorrectly placed kitchens, main switches, inverters, anti-elements/colors, transformers, electrical panels, boilers, pantries, wrong main door zones, and master bedrooms in the South-East.

Zinc Helix

The Zinc Helix, shaped to align with the North-East's attributes, is a Vastu remedy to activate and balance its water element. The North-East is a crucial zone for clarity, mind, meditation, prayer, or study, requiring utmost purity. This helix effectively corrects defects like low or cut corners, toilets, kitchens, pillars, staircases, master bedrooms, anti-elements/colors, and electricity-induced stress. It can be placed in sets of 3 or 9, vertically or horizontally, or concealed within walls.



Brass Helix

The Brass Helix is specifically designed to activate and balance the Space/Wind element in the North-West, the zone of support and banking. It's an excellent remedy for defects like roof slope towards NW, higher flooring, toilets, cut or extended zones, and open space in the North-West. Install 3, 9, or multiples, concealed in the floor/ceiling, or hung/placed in ready structures.



Iron Helix

The Iron Helix, designed for the West direction, activates and balances the Space/Wind element, a zone associated with gains and profits. It's a key remedy for West corner defects like:

1. Toilet
2. Cut or Extended zone

Install 3 or 9, or multiples based on area or expert advice. It can be concealed in floors/ceilings, or hung/placed in ready structures.



Copper Helix

The Copper Helix is designed to activate and balance the fire element in the South-East, the zone of cash and liquidity. It embodies the powerful "Hreem" mantra, representing cosmic heart, divine light, wisdom, and healing.

This helix is a prime remedy for South-East defects such as:

1. Wrongly located kitchens, main switches, or inverters.
2. Presence of anti-elements or colors.
3. Misplaced transformers, electric panels, boilers, or pantries in business settings.
4. A master bedroom in the South-East.



Install 3 or 9, or multiples thereof, based on the area or expert advice. It can be concealed in floors or ceilings, or hung, nailed, or placed on the floor in existing structures.

Lead Helix

The Lead Helix, designed for the South-West, activates and balances the earth element. This zone is associated with the "Gum" mantra, representing Ganesh's energy for obstacle removal and big-picture awareness.

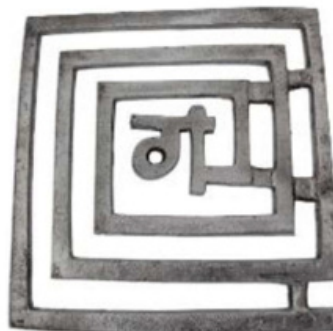

It's a prime remedy for South-West defects, including:

1. Fire placement, toilets, or cut zones.
2. Anti-elements/colors.
3. Transformers, electric panels, boilers, or pantries in businesses.
4. Kitchens causing female sickness.
5. Electricity leading to fire accidents.
6. Lower flooring/slope causing business losses.
7. Borewells/underground water tanks leading to shorter life spans.
8. Open space causing low productivity.

Install 3 or 9 (or multiples) concealed in the floor/ceiling, or hung/placed in ready structures.

Copper Helix

The Copper Helix Frame is designed to activate and balance the fire element in the South-East, the zone of cash and liquidity. It incorporates the powerful “Hreem” mantra, signifying cosmic heart, divine illumination, wisdom, and healing (physical and mental). Hreem also bestows magical force, empowerment, joy, ecstasy, and bliss.

This frame is an excellent remedy for South-East defects such as misplaced kitchens, main switches, inverters, anti-elements/colors, business transformers/panels/boilers/pantries, and master bedrooms. Install 3 or 9 (or multiples) concealed in the floor/ceiling, or hung/placed in existing structures.



Lead Helix Frame

The Lead Helix Frame is designed to activate and balance the earth element in the South-West corner. It incorporates the “Gum” mantra, representing Lord Ganesh’s energy for removing obstacles, bringing success, and fostering awareness, knowledge, and wisdom.

This frame is an excellent remedy for South-West defects, including:

1. Fire placement, toilets, or cut zones.
2. Anti-elements/colors.
3. Business-related transformers, electrical panels, boilers, or pantries.

4. Master bedrooms at South-East (typo, should be South-West for this helix).
5. Kitchens causing female sickness.
6. Lower flooring or slopes leading to business losses.
7. Borewells or underground water tanks causing shorter life spans.
8. Open space resulting in lower products or productivity.

For ready structures, it can be hung, nailed, or placed on the floor.

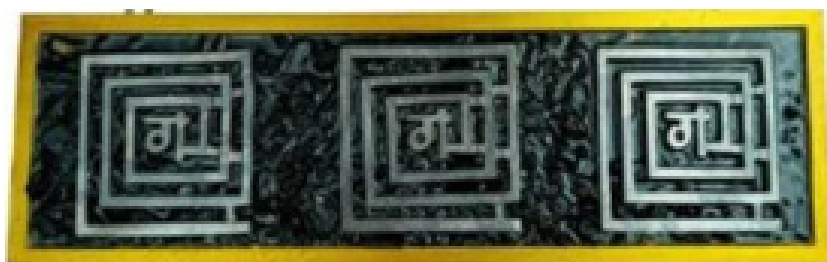

Brass Helix Frame

The Brass Helix Frame activates and balances the Space/Wind element in the North-West corner. It's an effective remedy for North-West defects such as:

1. Water bodies
2. Roof slope towards NW
3. Higher flooring
4. Toilets
5. Cut or extended zones
6. T-Junctions
7. Open space at North-West

Install 3 or 9 (or multiples) concealed in the floor/ceiling, or hung/nailed/placed in ready structures.



Zinc Helix Frame

The Zinc Helix Frame, aligning with the North-East's attributes, activates and balances its vital water element. This sacred zone, crucial for clarity, mind, meditation, and study, demands purity. The frame is a powerful remedy for North-East defects including:

1. Low or cut corners
2. Toilets
3. Kitchens
4. Pillars or staircases
5. Master bedrooms
6. Any anti-element or color
7. Stress and tension caused by electricity



Chapter 18

Vastu Spring and its uses

Anticlockwise Spring

Water Element - Black Wavy Round Spring

The Vastu Black Wavy Round Anticlockwise Spring, representing the Water element in both color and shape, is designed to boost specific energy fields or Devtas. It can be placed on or inside the ground, or affixed to a sidewall, as advised by Vastu experts.



Wood Element - Green Conical Anticlockwise Spring

This anti-clockwise spring, precisely crafted in shape and color to represent the Wood element, is designed to boost specific energy fields or Devtas. You can place it on the ground, embed it, or adhere it to a sidewall, as recommended by Vastu experts.



Fire Element - Red Triangular Anticlockwise Spring

This red, triangular, anti-clockwise spring is precisely crafted to embody the Fire element. Its design and color accurately represent this 'Tatva'. You can use this spring to boost specific energy fields or Devtas in your space. For installation, place it on the ground, embed it, or attach it to a sidewall, following the guidance of Vastu experts.

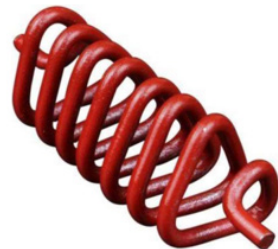

Space Element - White Round Spring

This white, round, anti-clockwise spring is precisely crafted to embody the Space element. Its design and color accurately represent this 'Tatva'. You can use this spring to boost specific energy fields or Devtas in your space. For installation, place it on the ground, embed it, or attach it to a sidewall, following the guidance of Vastu experts.



Earth Element - Yellow Square Spring

This yellow, square, clockwise spring is precisely crafted to embody the Earth element. Its design and color accurately represent this 'Tatva'. You can use this spring to hinder or balance specific energy fields or Devtas in your space. For installation, place it on the ground, embed it, or attach it to a sidewall, following the guidance of Vastu experts.



Chapter 19

Stud and its uses

Vastu Aluminum Stud

The Aluminum Stud is used in Vastu to balance and enhance the Water element's energy. You can strategically place these studs in areas with extensions, cuts, or toilets, particularly where the Water element is present, to correct imbalances in your home or office.



Stainless Steel Stud

The Stainless Steel Stud is used in Vastu to balance and enhance the Air element's energy. You can place these studs in areas of your home or office with extensions, cuts, or toilets, specifically where the Air element is present, to correct energetic imbalances.



Vastu Copper Stud

The Copper Stud is used in Vastu to balance and enhance the Fire element's energy. These studs can be strategically placed in your home or office to rectify issues like extensions, cuts, or toilets in areas associated with the Fire element.



Vastu Brass Stud

The Brass Stud is used in Vastu to balance and enhance the Earth element's energy. You can place these studs in your home or office in areas with extensions, cuts, or toilets, specifically where the Earth element is present, to correct energetic imbalances.



Vastu Iron Stud

The Iron Stud is used in Vastu to balance and enhance the Space element's energy. You can place these studs in your home or office in areas with extensions, cuts, or toilets, specifically where the Space element is present, to correct energetic imbalances.



Chapter 20

Vastu Programming or Balancing

It's a common observation that people from certain regions exhibit distinct characteristics, like aggression, fear, inquisitiveness, or artistic inclination. This regional influence explains phenomena such as Japan's lead in miniaturization, Germany's technical advancements, or Switzerland's growth in pharmaceuticals. A compelling example of topography's effect is Mr. Jimmy Carter's 1970s visit to China. Suffering from acute appendicitis, he received local acupuncture treatment. Upon re-examination in the U.S., his appendix was found perfectly fine, eliminating the need for surgery. Impressed, he sent a research team to explore oriental knowledge.

Virtually all life's problems can be addressed with Vastu Shastra. Vastu is a gift from Mother Nature, enabling us to create an environment conducive to fulfilling our desires. While it's impossible to list every Vastu offering, understanding its core principles provides a glimpse into its potential for daily life.

Symbols serve as a vital medium for communication between human beings' inner selves and the mysterious forces of Nature. Aparajit, the first sculptor, immortalized the invisible by creating "symbol-sculptures." Symbols are powerful, possessing their own language and effects, having guided human evolution since ancient times. They are integral to the conscious and subconscious mind, with linguistics even suggesting language developed from them. The human subconscious mind solely understands the "language of symbols."

The subconscious mind expands into two domains: the human inner mind and a building's inner space. The human mind is programmed by its living environment—the space within a building.

Before applying Vastu remedies, the first three steps of the 4-step Vastu process must be completed in your building. Caution is advised when using symbols, as this forms the fourth and final step, providing the “finishing touch” for desired manifestation. Only after thorough understanding and practical



observations should one decide on a course of action for life's problems. Avoid haste; nature works at its own pace but is profoundly effective. If multiple issues need addressing, tackle them one by one.

The judicious use of Vastu symbols and remedies, discussed hereafter, can completely transform your life.

Performing Nabhi Viddhi

Nabhi Viddhi is a Vastu practice designed to enhance the energetic core of a space. Here's how to perform it:

1. **Prepare the Plate:** Get a 6x6 inch copper plate. On this plate, carefully place the gemstones specified in the provided table (from Serial No. 2 to 10 and Serial No. 16).
2. **Secure Gemstones:** To keep the gemstones in place, either glue them onto the plate or wrap the entire plate with cello tape.
3. **Dig the Pit:** At the center (Brahmasthan) of your property, dig a pit approximately 1 to 1.5 feet deep.
4. **Place the Plate:** Carefully lower the copper plate into this pit.
5. **Optional Rituals:** If you wish, you can perform Pujas or chant Mantras at this stage.
6. **Backfill and Finish:** Fill the pit with sand over the plate. Afterward, you can proceed with fixing marble or tiles for your flooring.

Important Considerations:

- **Ideal Time:** The best time to perform Nabhi Viddhi is between 6-7 AM.
- **Day:** It can be performed on any day. However, if you're including gold with the Nabhi Viddhi, Sunday is the preferred day.
- **Gemstone Quantity:** The gemstone quantities listed in the table are for an area of around 1500 sqft. Adjust the quantity based on your plot's size.

Just as a baby receives essential nourishment via the umbilical cord, your home needs foundational “minerals and vitamins” for its well-being. Performing Nabhi Viddhi with natural stones in your Brahmasthan energizes the space, providing vital support. Ensure placement is done by a Vastu consultant, Pandit Ji, or family members, not by laborers.

KUBER

Makes You Rich



Vastu Zone of Placement	North
Zonal Energy	Creates wealth and fortune
Placement Procedure	Place on a table or shelf
Facing	South
Planet	Mercury
Element	Air

Yakshraj Kuber, the wealthiest deity and guardian of universal treasures, translates actions into riches and growth, bringing bliss and abundant wealth. As the guardian of the North, place his statue there on a table or shelf. To attract money and richness, combine Kuber in the North with a pair of Red Horses in the South, ensuring career growth and business success.

PAIR OF RED HORSES

Let Money Flow Quickly



Vastu Zone of Placement	South
Zonal Energy	Converts your action to a steady flow of wealth through fame and recognition.
Placement Procedure	Place on a table or shelf
Facing	South
Planet	Mars and Moon
Element	Fire and Water

Placing a pair of red horses in the South zone, facing North, ensures a steady flow of money. In Vastu, the South governs fire, while horses embody the water element. The color red, however, harmonizes these opposing forces, much like the balance found in the Manipura chakra. Red horses optimize your efforts, converting them into money and recognition. This remedy invigorates public relations, helping establish a respectful reputation in both business and social circles.

CAMEL

Increases Productivity and Profits



Vastu Zone of Placement	West
Zonal Energy	Increases stamina to work continuously, thus increasing productivity.
Placement Procedure	Place on a table or shelf
Facing	Centre of the building
Planet	Mars
Element	Earth

If you’re overburdened with work, yet experiencing disproportionately low returns, the Vastu camel offers a unique solution. Place a camel statue on the floor in your West zone, facing the building’s center. This remedy helps alleviate work pressure, simultaneously increasing profits and benefits. It also fosters stable business relationships and encourages your team to work tirelessly with dedication, directly boosting productivity and commitment towards organizational goals.

PAIR OF WHITE HORSES

Ensure Smooth Banking

PAIR OF WHITE HORSES
Ensure Smooth Banking



Vastu Zone of Placement	North -West
Zonal Energy	Encourages banks and financial institutes to provide you with money (loans)
Placement Procedure	Place on a table or shelf
Facing	Centre of the building
Planet	Moon
Element	Water and Space

To secure loans and fulfill financial needs, place a pair of white horses on the floor in your building’s North-West zone, facing the center. This remedy effectively removes financial obstacles, ensuring smoother money flow and improved access to funds, especially in partnerships. For those seeking a salary increase, these white horses activate the North-West’s energy, encouraging banks and financial institutions to provide monetary support, making a higher pay package a reality.

NANDI BULL

Secures Your Business



Vastu Zone of Placement	South -West
Zonal Energy	Protects a business, and promotes trust and loyalty
Placement Procedure	Place on a table or shelf
Facing	North - east direction
Planet	Saturn
Element	Space

Lord Shiva's Nandi bull provides protection against unforeseen business calamities. Place it in the South-West zone of your building, along the west wall. Beyond protection, Nandi fosters long-term, faithful partnerships and collaborations. Public limited companies and institutions can enhance client and customer trust and loyalty with Nandi. In shops, it attracts more customers, ensuring their satisfaction. To foster team loyalty and better connect with executors, place an Indra Dev statue in the East, the zone of social associations.

RABBITS

Develops Beneficial Business Connection



Vastu Zone of Placement	South -West
Zonal Energy	Protects a business, and promotes trust and loyalty
Placement Procedure	Place on a table or shelf
Facing	North - east direction
Planet	Saturn
Element	Space

Placing a pair of black and white painted brass rabbits on the floor in your building's East-South-East (ESE) zone will activate your connections. This Vastu remedy ensures your network becomes beneficial, yielding returns and even rewarding unknowingly done actions. These rabbits excel at forging useful business and career relationships, ensuring your efforts are recognized and converting expenditures into profitable returns.

12 WHITE HORSES

Ensure beneficial investments by placing 12 white horses in the north - north- west zone.



Vastu Zone of Placement	North - North - West
Zonal Energy	Improves life and makes investments beneficial.
Placement Procedure	Place on a table or shelf
Facing	Centre of the building
Planet	Moon
Element	Water

According to Vastu, placing a sculpture of 12 white horses on the floor in your building's North-West zone helps secure funds for land and construction. In industry, this remedy aids in generating capital investments and acquiring machinery funds from financial institutions.

For quick, profitable property sales, place a new building model in the North-North-West zone with the 12 white horses atop it. To maximize profits from land investments and procure properties at good prices, combine 12 white horses in the North-North-West, an Eagle in the South-West, a village scene in the West-South-West, and a red elephant in the South.

12 RED HORSES

Ensure effective marketing and brand building by placing 12 red horses in the south zone.



Vastu Zone of Placement	South
Zonal Energy	Helps you to establish yourself or your company through marketing and brand building.
Placement Procedure	Place on a table or shelf
Facing	North
Planet	Mars and Moon
Element	Fire and Water

Place a sculpture of 12 red horses on the floor in your building's South zone. In Vastu, this promotes your company and builds a strong dealer network, leading to increased profits. These horses stimulate market development, boost sales, and establish your brand. They enhance satisfaction by improving returns on efforts, foster teamwork, ensure high product quality and recognition, and help your company dominate its market through superior marketing and brand building.

LION

Makes You Powerful and Majestic



Vastu Zone of Placement	North - North - East
Zonal Energy	Produces glory, magnificence and authority.
Placement Procedure	Place on a table or shelf
Facing	Centre of the building
Planet	Jupiter
Element	Earth

Placing a brass lion on the floor in your building's North-North-East zone offers several benefits. You'll notice your personality strengthening and a greater influence on society. If you need to appear influential, particularly with government organizations, use this remedy. The brass lion also ensures a steady flow of wealth derived from your company, business, and personal influence. Your loved ones will immediately observe your personality and aura becoming empowered, like a lion.

SURYA DEV

Grants Regal Power



Vastu Zone of Placement	East
Zonal Energy	Enables political power and social connections, ensures successful meetings and gatherings.
Placement Procedure	Hang on the wall at a height of 7 feet the floor
Facing	West direction
Planet	Sun & Mercury
Element	Fire

According to Vastu, Surya Dev (the sun) represents governing power and fosters relationships with influential people. To leverage the support of powerful individuals for business success, a copper or brass sun Vastu remedy is highly effective. It helps you use wisdom and skill to build relationships that enhance your glory, name, and reputation.

Hang this powerful sun remedy on the eastern wall of a building, 7 feet from the floor. Caution: Ensure the sun's expression is solemn, earnest, gentle, benevolent, or peacefully smiling—avoid depictions of pain, stress, or anger. For combined power and fame, place 12 red horses in the South (fame zone) along with the sun in the East (social associations zone).

CHESSBOARD

Makes You Confident of Your Abilities



Vastu Zone of Placement	West and North
Zonal Energy	Generates business acumen, political influence, attentiveness to details and increasing efficiency.
Placement Procedure	Hang on the wall or place on a table
Facing	NA
Planet	Ketu
Element	Water

Placing a chessboard in the West zone can awaken your latent talents, helping you utilize your skills effectively at the right moment. If your work output doesn't match your abilities, this remedy empowers you to perform at your best. It also restores confidence when you feel your accumulated knowledge is lost, providing the strength to rebound. At home, a chessboard in the West ensures your children excel in their professional studies.

EAGLE

Sharpens Your Skills



Vastu Zone of Placement	South - West
Zonal Energy	Improves skill, ability, concentration and awareness.
Placement Procedure	Place on a table or shelf
Facing	North - East
Planet	Sun and Mercury
Element	Fire and Space

The Garuda, Lord Vishnu's mount, is a metaphysical symbol representing the skill needed to manage and run a system. By placing an eagle sculpture on a table in the South-West zone, facing North-East, you can sharpen these crucial abilities. As the zone of skill, the eagle here will enhance your existing talents, helping you set new standards in your work. Just as the eagle symbolizes special administrative power and respect for nations like the USA and Dubai, its presence in your space can elevate your capabilities and influence.

DANCING DOLPHINS

Ensures Your Best Performance



Vastu Zone of Placement	East - South - East
Zonal Energy	Enhances your work and improves performance.
Placement Procedure	Place on a table or shelf
Facing	Can face any direction
Planet	Rahu
Element	Water and air

If your repetitive performances lack perfect results, placing dancing dolphins in your building's East-South-East (ESE) zone can significantly improve them and boost client satisfaction. This remedy helps overcome such situations and reduces unexpected delays. The dolphins create a unique balance between fire and water elements in the ESE, especially benefiting artists and creatives by bringing perfection and beauty to their work. They also increase work capacity, ensure outstanding results, speed up processes, and help you leave a lasting impression of your skills.

PYRAMIDS

The Enhancers



Vastu Zone of Placement	NNW, north, NNE, NE, ENE, EAST, WSW and the west
Zonal Energy	As per the zone.
Placement Procedure	Flat on the floor
Facing	Along the north - south axis
Planet	Mars
Element	Fire, earth and space

The pyramid, literally meaning ‘fire center,’ is a powerful ancient symbol found atop many religious structures globally. When used in Vastu, pyramids amplify a zone’s energy by approximately 108 times, making their placement crucial. They are effective in eight specific Vastu zones; incorrect placement in the other eight can have devastating effects and must be avoided.

Beneficial Pyramid Placements:

- **North-North-West:** Improves sex life.
- **North:** Enhances money-attracting energy.
- **North-North-East:** Promotes health.
- **North-East:** Imparts clarity of mind.

A pyramid can reduce negativity and amplify energy in imbalanced zones where an activity's purpose clashes with the zone's inherent energy.

Important Cautions: Always place pyramids on the floor and align them along the north-south axis. Never stick them on walls, doors, or ceilings, as this can be dangerous.

While powerful alone, pyramids offer even greater benefits when combined with other Vastu remedies:

- **Government Work:** Place an Ashoka Pillar in the North-West (table) and a pyramid in the North (floor).
- **New Opportunities:** Pyramid in North (floor) and a brass lion in North-North-East.
- **Fulfill Desires:** Pyramid in West (floor) and a Kamdhenu cow in East-South-East.
- **Middle Eastern Business:** Pyramid in North (floor) and a camel in West.
- **Career Start:** Pyramid in North-East (floor) and fresh flowers in a vase in North.
- **Health & Protection:** Pyramid in North-North-East (floor) and a yellow earthen vase in South-South-West.

Placing a pyramid in the zones associated with sex enhances satisfaction.

SWASTIKA

Improve children's studies by placing swastika in the west - south- west zone.



Vastu Zone of Placement	Can be placed in any direction
Zonal Energy	As per the zone of application.
Placement Procedure	On the wall
Facing	NA
Planet	Jupiter
Element	Space

The Swastika, a universal symbol across ancient civilizations, helps balance and align with cosmic energy. Imbalance is the source of all problems. By simply drawing a Swastika, any space can be harmonized with divine forces, igniting a spark for natural balance. When placed in the North-North-East (health zone), it promotes good health and quick recovery. Hung on the eastern wall in the North-East zone, it brings mental peace.

LUSH GREEN LANDSCAPE
Creates New Opportunities



Vastu Zone of Placement	North
Zonal Energy	Creates new opportunities. Generates recognition, respect and fame from work done.
Placement Procedure	On the wall
Facing	NA
Planet	Mercury
Element	Air

Hanging a painting or photograph of a lush green landscape or healthy green crops on the North wall offers multiple benefits. It attracts new career prospects, fosters business growth, and yields quick results for overdue promotions or jobs not matching qualifications. If your business feels constrained, this remedy can open exciting new opportunities, expanding your sphere of work.

KAMDHENU COW

Fulfils Your Desires



Vastu Zone of Placement	East - South - East
Zonal Energy	Remove inner conflicts. Enables one to benefit from social systems and policies.
Placement Procedure	Place on a table or shelf
Facing	West-North-West (WNW)
Planet	Venus
Element	Fire and Space

The Kamdhenu Cow, a divine gem from Pauranic tales, when placed on the floor in your building's East-South-East zone, transforms internal conflict into productive action, helping fulfill wishes. This sacred cow, known for its heavenly powers, effectively attracts profits from land and agricultural technology, and aids in successfully completing projects in mining, construction, and structural design.

DEER

Gives Speed and Agility



Vastu Zone of Placement	West - North - West (WNW)
Zonal Energy	Infuses more vital energy
Placement Procedure	Place on a table or shelf
Facing	North
Planet	Mars
Element	Air and Fire

To remove stress, stagnation, or lethargy, place a brass Deer sculpture on the floor or a table in your building's West-North-West zone, facing North. This remedy detoxifies your mind, infuses youthful energy, and speeds up sluggish systems, smoothing out tangled situations. The Deer not only brings efficiency but also enhances skill and coordination within your company, attracting dedicated individuals. It encourages people to perform beyond expectations, boosting overall work quality.

TORTOISE

Experience Longevity and Patience by Placing



Vastu Zone of Placement	Centre of Building or West
Zonal Energy	Generates patience and the success that come from it gives perseverance.
Placement Procedure	Place on a table or shelf
Facing	North
Planet	Jupiter & Moon
Element	Earth

The tortoise, a revered ancient Vastu remedy, brings a profound sense of peace, often felt in old temples where it was centrally placed. For success and benefits, position it in the West. For stability, patience, and perseverance, place it in the center of your building, facing North.

The tortoise protects you from unproductive efforts, ensures mental peace, promotes good health, and guides you toward continuous success. It empowers you to overcome adversity, preventing you from losing heart under pressure. To cultivate inner wisdom, cleanse the North-East (clarity zone), place a pyramid there, and put a tortoise at your home's center.

INDRADEV

Creates Organised Systems



Vastu Zone of Placement	East
Zonal Energy	Makes the organisational energies more effective and helps to make the required connection.
Placement Procedure	Place on a table or shelf
Facing	West
Planet	Sun
Element	Fire and Air

Indra Dev, also known as Mahendra in the Vedas and Lord of Swargaloka, symbolizes smooth functioning, bliss, and luxury. Placing his sculpture on a table in the East zone, facing West, will help you forge new connections and attract skilled individuals to your business. This remedy also removes obstacles in new projects and government dealings, increasing your chances of winning government contracts and deals.

GREEN MOUNTAINS

Creates a Co-Operative Team with a picture of Green Mountains in the West-South west Zone.



Vastu Zone of Placement	West - South - West (WSW)
Zonal Energy	Helps to get success through corporation.
Placement Procedure	Hang on the wall
Facing	NA
Planet	Sun and Mercury
Element	Fire, Air and Space

A painting or photograph of lush green mountains, ideally with a golden frame, is a powerful Vastu remedy. Hang it on the wall in your West-South-West zone. This ensures you gain the collective support of a successful team, fostering cooperation among employees and helping them utilize their skills optimally. This remedy leads to increased business, improved communication, and a better accounting system, ensuring your business scales new heights.

RED ELEPHANTS

Brings in Fame and Recognition



Vastu Zone of Placement	South
Zonal Energy	Gives fame and recognition.
Placement Procedure	Place on a table or shelf
Facing	Centre of building
Planet	Rahu and Mars
Element	Space, Fire and Earth

The red elephant brings both fame and recognition. You can place it in the North zone, South zone, or both simultaneously, depending on your desired outcome.

When placed in the South zone, it brings you personal fame and recognition in your field of work. In the North zone, it makes your firm, company, or organization famous and well-respected. Placing it in both zones ensures both personal and organizational acclaim.

The red elephant also brings strength, abundance, and success. Always ensure the elephant faces the center of the building when placed.





Chapter 21

Frequent Ask Questions

Q1. If the South South West (SSW) is weak or extended, can a yellow vase be used for balancing it, or is it only for weak zonal strength?

Ans. Yes, a yellow vase, representing the Earth element, can be used for balancing a weak or extended SSW zone.

Q2. Does the Vastu Purush Mandal only occupy the central portion of a square plot?

Ans. No, the Vastu Purush Mandal can be proportionally drawn on a rectangular plot, with varying distances between lines on the perpendicular sides.

Q3. If the West-North-West (WNW) is cut or weak in a building, what kind of symptoms will it create?

Ans. A weak or cut WNW zone can lead to feelings of depression and low moods.

Q4. What is the ideal location for an overhead tank (OHT)? South or South West? Does it affect residents, as it's not occupied space?

Ans. OHTs can be placed in the South or South West zones. Their effects typically don't appear if placed more than three floors above the residents' floor. However, symptoms should still be checked, and remedies applied if necessary.

Q5. If property papers are kept in the West, does the file color matter? If so, what color?

Ans. White or yellow colored files are suitable for property papers in the West.

Q6. A toilet in the North & North-North-East (NNE) is a strict no. If one already exists and causes problems, should the toilet seat be completely removed or is sealing it fine?

Ans. Removing the toilet seat completely is ideal, but sealing it will also be effective.

Q7. Since Kuber Ji is to be placed in the North, can his sculpture be made of Brass?

Ans. Yes, a Kuber Ji sculpture can be made of brass, as the main programming is by the sculpture's form, not solely its material.

Q8. If business projects always take too long (e.g., 1 year takes 2), leading to fines, which zones are responsible?

Ans. The East-South-East (ESE) zone is the primary reason for project delays, though other zones can also contribute.

Q9. What do clockwise stairs in the North-East zone bring?

Ans. Clockwise stairs in the North-East zone reduce clarity of mind and hinder the conception of new ideas.

Q10. Where should a Mandir (temple) be kept in the house?

Ans. The North-East zone, being for clarity and meditation, is ideal for a Mandir. Deities should face West, and you should face East or North-East.

Q11. Kidney problem: Which zone and what are the tips?

Ans. Kidney problems are linked to an imbalance in the North-North-East (NNE) Vastu zone. Avoid placing inverters, dustbins, toilets, and storage there.

Q12. Can we keep a cashbox in the South-East?

Ans. Yes, a cashbox can be kept in the South-East zone.

Q13. In which zone should a garbage can, broom, etc., be placed?

Ans. Ideally, garbage cans and brooms should be placed in the South-South-West (SSW) Vastu zone.

Q14. As the West direction is for gains, does a chessboard here cause ups and downs, as chess signifies it?

Ans. No, when applied in a balanced West zone, a chessboard yields only positive results.

Q15. Please tell me the color and material of a pyramid?

Ans. Pyramids should always be made of plastic or wood, and can be wooden or white in color.

Q16. Can I keep a wooden or crystal type pyramid on a table in the North-North-East? Please mention the size also.

Ans. Pyramids should always be placed on the floor only. Wooden is acceptable, but avoid crystal pyramids. The base size should be a minimum of 4 inches.

Q17. In the North of my house is the toilet and bathroom. Do you suggest keeping the pyramid in the toilet? I am facing too much financial problems, is it because of the toilet? What should I do? Should I put some yellow stripes. Is it OK to keep the pyramid in the bedroom?

Ans. A toilet in the North is a major reason for financial problems. Keeping a pyramid in (or near) the toilet in that zone will help. Yellow stripes are not the primary solution here. It is generally okay to keep a pyramid in the bedroom, but its placement should follow Vastu guidelines.

Q18. Where to keep the cash counter in shops and what should be done to cater to the element part (if there is an imbalance) in this zone?

Ans. Generally, a cash box can be kept in the North zone. However, placement depends on available space and the shop's facing. Standard remedies for elemental balance cannot be prescribed without a complete Vastu analysis of the shop.

Q19. It is well mentioned in the Vastu zones that the South-East (SE) is the cash and liquidity zone. So, is it good if I keep the cash counters in this zone for cash transactions?

Ans. Yes, a cash counter can be made in the South-East zone.

Q20. My flat has an East entrance and a North entrance. Which door should I use?

Ans. Both East and North entrances are perfectly fine if they are in beneficial locations. Once confirmed, you can use either door based on convenience.

Q21. Where should the toilet be placed?

Ans. Toilets can be placed in the South-South-West (SSW) Vastu zone.

Q22. Which color should we use for the walls in the South?

Ans. You can paint off-white color in the South zone.

Q23. What is the other option for an overhead water tank except the West Vastu zone? Is the North zone, OK?

Ans. The North zone is not suitable for an overhead water tank. The South-West (SW) zone is a suitable alternative.

Q24. Could you please tell me which is the ideal place/direction for Red Color in a house?

Ans. The ideal directions for red color in a house are the South East, South-South-East (SSE), and South zones.

Q25. When should a Vastu remedy be applied? Is there a particular time or an auspicious day or date that must be kept in mind when applying Vastu remedies?

Ans. No, you do not need to wait for an auspicious moment to apply a Vastu remedy. Auspicious times are for starting something new. Remedies can be applied at any convenient time or day, as their purpose is to correct imbalances and restore harmony.

Q26. Are Vastu remedies objects of worship?

Ans. Vastu remedies are not objects of worship, but they should be cared for and kept in clean areas. They are akin to decorative objects used to enhance a space's aesthetic appeal.

Q27. If a Vastu remedy breaks, is it considered a bad omen? Should a broken remedy be submerged in a river or a water body?

Ans. A breaking Vastu remedy is not a bad omen; often, it's considered a good omen symbolizing the departure of negative vibrations. Do not submerge broken remedies in water bodies as it causes harm. The traditional method is to bury them in an unused area of land. If not possible, dispose of them carefully, ensuring they are not mixed with garbage.

Q28. Is it necessary to consult a certified Vastu Expert when applying remedies?

Ans. For complex Vastu-doshas (defects), consulting a certified Vastu expert is advisable. An expert can assess whether problems are Vastu-related, their extent, and prioritize the application of remedies.

Q29. What should I do with a remedy after getting the desired results?

Ans. Vastu remedies can be left in place even after desired results are achieved, as they continue to have beneficial effects. If you wish to remove them, store them carefully along the West wall or gift them to friends and loved ones.

Q30. Can a Vastu remedy be gifted? Are there any norms for giving or receiving Vastu remedies?

Ans. Vastu remedies have been gifted for centuries, benefiting both giver and receiver. However, this does not apply to statues or pictures of Devis and Devtas intended for worship; giving and receiving these is a harmful practice.